

WEST BENGAL MEDICAL SERVICES CORPORATION LTD

(Wholly Owned by the Government of West Bengal)

CIN: U85110WB2008SGC126373

Regd. Off. : Swasthya Sathi, GN-29, Sector-V, Salt Lake, Kolkata-700091

Telephone: (033) 40340300 | Fax: (033) 40340400

E-mail: info@wbmsc.gov.in | Website: www.wbmsc.gov.in

Memo No.: HFW-41012(23)/1/2018-WBMSCL SEC-Dept. of H&FW/AAES-820/0242

Date:01/02/2019

ORDER

Administrative Approval and Expenditure Sanction is hereby accorded for 'Electrical installation works for the proposed Mother & Child Hub at Anupnagar Block Primary Health Centre of Samserganj Block of Murshidabad District' at an estimated cost of Rs. 4,68,71,907.00 (Rupees Four Crore Sixty Eight Lakh Seventy One Thousand Nine Hundred Seven) only as per approved vide AAFS no. FBMNC/13N/2017/(Anupnagar BPHC)/205 Dt 16/01/2019 under Nation Health Mission of Family Welfare Department, Government West Bengal.

The details of the allocation are as follows:

Sl. No.	Particulars	Amount (Rs.)
1	'Electrical installation works for the proposed Mother & Child Hub at Anupnagar Block Primary Health Centre of Samserganj Block of Murshidabad District'	4,57,28,690.00
2	Contingency @ 2.5%	11,43,217.00
Total:		4,68,71,907.00

The work will be executed by the Executive Engineer, P.W.D, Murshidabad Electrical Division & e.o. Ex-Officio Executive Engineer, West Bengal Medical Services Corporation Limited as per procedure laid down in the order of the Health & Family Welfare Dept. vide no. HF/O/MS/384/W-39/12 dated 01.06.12 read with Notification No. 86-W(C)-1M-106/11 dated 06.02.12 and Memorandum no 37-W(C)-1M-106/11 dated 17.01.2012 of Public Works Department, Government of West Bengal.

Handwritten signature

Managing Director

Date:01/02//2019

Memo No: HFW-41012(23)/1/2018-WBMSCL SEC-Dept. of H&FW/AAES-820/0242/1(9)

Copy forwarded for information and necessary action to:

1. Programme Officer, NHM & Deputy Secretary, H&FW Dept.
2. CMOH, Murshidabad.
3. Superintending Engineer, PW Dte., Central Electrical Circle & Ex-Officio Superintending Engineer, West Bengal Medical Services Corporation Limited
4. Manager (Accounts), West Bengal Medical Services Corporation Limited
5. Executive Engineer, P.W.D, Murshidabad Electrical Division & e.o. Ex-Officio Executive Engineer, West Bengal Medical Services Corporation Limited
6. Block Medical officer of Health, Samserganj Block, Murshidabad
7. Consultant Project Engineer (Civil), WBMSCL
8. Consultant Project Engineer (Civil), WBMSCL
9. Office Copy

Handwritten signature

Managing Director



Government of West Bengal
Health & Family Welfare Department
National Health Mission



GN-29, 4th Floor, Swasthya Sathi Building, Swasthya Bhawan Premises,
Sector - V, Salt-Lake, Bidhannagar, Kolkata - 700091
(Phone) 033-2333 0238; (Fax) 033-2357 7930
Email: ponhmwb1@gmail.com / po_nrhm@wbhealth.gov.in;
Web: www.wbhealth.gov.in

No. FBMNC/13N/2017/(Anupnager BPHC)/ 205

Dated. 16/01/2019

ORDER

Administrative approval and financial sanction for the scheme 'Electrical installation works for the proposed Mother & Child Hub at Anupnager Block Primary Health Centre of Samserganj Block of Murshidabad District' at an estimated cost of Rs. 4,78,87,084.00 (Rupees Four Crore Seventy Eight Lakh Eighty Seven Thousand & Eighty Four) only.

2. The abovementioned sanctioned amount is inclusive of Rs. 21,58,394.00 (Rupees Twenty One Lakh Fifty Eight Thousand Three Hundred & Ninety four) only as 4.72% administrative charges admissible to West Bengal Medical Service Corporation Limited.

Detail noted hereunder:

Sl. No.	Nature of the Work	Estimated amount (In Rs.)	4.72% administrative charges (In Rs.)	Total Estimated Amount (In Rs.)
1	Electrical	4,57,28,690.00	21,58,394.00	4,78,87,084.00

3. The work will be executed by the Executive Engineer, PWD, Murshidabad Electrical Division & e.o. Executive Engineer, West Bengal Medical Service Corporation Limited.

4. On receipt of requisition, fund will be released in favour of West Bengal Medical Service Corporation Limited for expenditure as per norms stated vide M.S Branch Order No. HF/O/MS/384/W-39-12 dt. 01.06.2012 read with Notification No. 86-W(C)-1M-106/11 dt. 06.02.2012 and Memorandum No. 37-W(C)-1M-106/11 dt. 17.01.2012.

5. Senior Accounts Officer, National Health Mission will be the drawing & disbursing officer in this regard after submission of requisition of fund by WBMSCL.

6. Utilisation Certificate shall be submitted by WBMSCL in due course.

7. The charge will be debitible under the head of accounts "Setting Up MCH Wing/ Hub" [Tally A/C Head -B.04.01.05.09]

8. No escalation beyond the amount for which the AAFS has been accorded, shall be allowed under any circumstances.

11. No other works, other than the scheme sanctioned are to be implemented/taken up against the approval proposed.

12. This is issued with the approval of Mission Director, National Health Mission & Secretary, Health & Family Welfare Department, Government of West Bengal.

13. All concerned are being informed

Shukla 16/1/19.
Programme Officer, NHM &
Deputy Secretary to the
Government of West Bengal.

No. HFW/NHM-343/2016/(5185)/20.5/1(13)

Dated. 16/01/2019

Copy forwarded for information & necessary action to:

1. Director of Health Services & e.o. Secretary, Health & Family Welfare Department.
2. Managing Director, West Bengal Medical Service Corporation Limited.
- ✓ 3. General Manager, West Bengal Medical Service Corporation Limited. Copy of the estimate is enclosed for kind reference.
4. Manager (Accounts), West Bengal Medical Service Corporation Limited.
5. Senior Accounts Officer, National Health Mission.
6. District Magistrate, Murshidabad.
7. Chief Medical Officer of Health & Secretary, DH&FWS, Murshidabad.
8. District Programme Co-ordinator, Murshidabad.
9. Assistant Engineer, DPMU, Murshidabad.
10. Deepak Debnath, SPMU, National Health Mission.
11. IT Cell with a request to upload this order on the website of this Department.
12. Copy for the Guard File
13. Office copy.

Shukla 16/1/19.
Programme Officer, NHM &
Deputy Secretary to the
Government of West Bengal.

Government of West Bengal
Office of the Chief Medical Officer of Health
Murshidabad

370

Memo No: CM / MSD / Dev-10798

DATE:- 18.12.2018

To
The Managing Director
WBMSC Ltd
Swasthya Bhawan
Salt Lake City, Kolkata-91

Sub:- Submission of Estimate for the work of – Construction of (G +3) storied Mother & Child Hub at the Premises of Anupnagar BPHC, Samsanganj Block , Murshidabad.

Ref:- Memo No- Order by Programme Officer, NHM (Vide No- HFW/NRHM-342/2016/5184/2815(1), dt. 29.05.2018

Estimated Cost- i) Civil Works ... = Rs. 16,54,33,095.00
ii) Electrical Works = Rs. 4,71,42,979.00
Total = Rs. 21,25,76,074.00

Respected Sir

Enclosed herewith please find two copies of Estimate for the above cited work at Anupnagar BPHC , Samsanganj Block, Murshidabad. duly countersigned by the undersigned for administrative approval & sanction of fund from your end please.

The Existing buildings are not capable to take huge patient load as well as delivery load. At present daily average delivery is 25. In this regard it is very much essential to build 300 bedded Mather & Child Hub.

Therefore Estimate is now prepared and sending to your kind end for necessary administrative approval please.

With best regards.

Encl-2 Copies Estimate.

Yours Faithfully

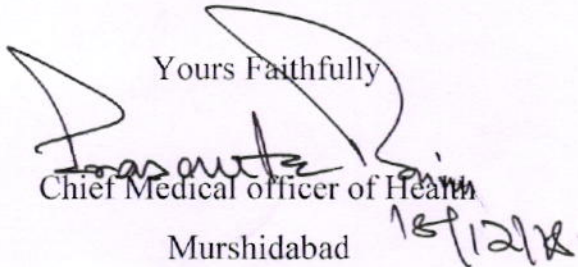
Chief Medical officer of Health

Murshidabad 18/12/18

Memo No: CM / MSD / Dev: 10798(7)

Dated:- 18.12.2018

Copy forwarded for kind information and necessary action to: -

1. The .Director of Health Service ,Swasthya Bhawan
2. The Mission Director, NHM, Swasthya Bhawan
3. The District Magistrate, Murshidabad
4. The Addl. Mission Director, NHM, Swasthya Bhawan
5. The Executive Engineer, PWD,Berhampore Division No-I & Murshidabad Electrical Division ,
6. The BMOH , Anupnagar BPHC, Samsanganj Block, Murshidabad

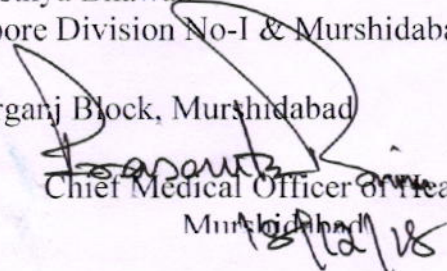
Chief Medical Officer of Health

Murshidabad 18/12/18

1

Government of West Bengal



सत्यमेव जयते

ROUGH COST ESTIMATE FOR :

~~Proposed Construction of~~ Proposed Construction of G+3
Storied Mother and Child Hub at the premises of Anupnagar
BPHC, Samsrganj Block, Murshidabad during the year
2018-19 (Foundation to be taken G+5)

TOTAL ESTIMATED COST

(Civil + Electrical)
(21,25,76,074=00.) ✓
Part=~~Rs 18,28,98,072.00~~

SCHEME PREPARED BY

JANGIPUR SUB-DIVISION
PUBLIC WORKS DEPARTMENT UNDER
BERHAMPORE DIVISION-I, PUBLIC
WORKS DEPARTMENT
GOVT. OF WEST BENGAL

:-REPORT:-

Name of the Work: Proposed Construction of G+3 Storied Mother and Child Hub at the premises of Anupnagar BPHC, Samsanganj Block, Murshidabad during the year 2018-19 (Foundation to be taken G+5)

Ref: Memo no CM/MSD/Dev-4902 dated Berhampore, 4th June 2018 of Chief Medical Officer Of Helth, Murshidabad, and order of the Programme Officer, NHM(Vide No-HFW/NRHM-342/2016/5184/2815(1), dt.29.05.2018

State Project Screening Committee meeting for building Project (spscb) under PWD held on 07.08.2018 at 1.00 p.m at PWD ,conference Hall 8th floor Nabanna .Some observation were noted during thread bear discussion on the project **Proposed Construction of Mother and Child Hub at Anupnagar BPHC, Dist- Murshidabad** . Accordingly WEST BENGAL MEDICAL SERVICES CORPORATION LTD was intimated the minutes of the above noted State Project Screening Committee meeting. The WEST BENGAL MEDICAL SERVICES CORPORATION LTD revised the drawing and the same drawing was forwarded to C.G.A. After getting verbal instruction from C.G.A this rough cost estimate has been framed incorporating revised drawing. In this estimate 7.0 m wide concrete road is considered.

This rough cost estimate has been framed to meet up the probable cost for the above-mentioned work. The above estimate has prepared as per requisition of Chief Medical Officer Of Helth, Murshidabad (enclosed) Memo no CM/MSD/Dev-4902 dated Berhampore, 4th June 2018.

Accordingly this rough cost estimate has been prepared as per approved drawing supplied by WEST BENGAL MEDICAL SERVICES CORPORATION LTD (05 Numbers). The rate for the same has considered as per Chief Engineer, Memo No. -1029/CE(HQ) /PWD dated 09.07.2014 for R.C. Frame Structure Rs. 3250.00/m³.

The proposed construction will be of four storied (G+3) building with provision of foundation G+5 storied and the building will be constructed at Anupnagar BPHC Compound Samsanganj Block, Murshidabad. So the Pile foundation is considered.

Separate monetary involvement for exterior acrylic primer & acrylic emulsion paint over external walls and vitrified flooring, putty, acrylic distemper are also considered in this estimate. Provision for Frame Structure

building with pile foundation (add 40% structural cost) of is considered along with internal Sanitary and plumbing works for the Building amounting 15% of structural cost are also considered in this estimate. The fire fighting and fire safety cost @3 % of structural cost and for soil investigation @ 1.00% of structural cost are also considered in this estimate. Separate estimates are prepared for **Land Development, Boundary wall, Sinking of Tube well , Compound Road, Surface Drain & Plinth protection ,Underground Reservoir, Horticulture work ,Electrical Sub -Station, Pump Room, 125 KV. D.G Shed .**

Agency own supply of materials are considered. The Electrical wing of P.W.D will submit separate estimate for internal and external electrification like compound light, glo sing board, lift etc.

Thus total cost stands of Rs. ~~18,28,98,072.00~~ (21,25,76,074=00) including 12% G.S.T, 1% Labour Welfare cess and 3% contingency.

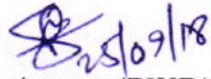
Assistant engineer, (PWD)
Jangipur Sub-Division

Executive Engineer,(PWD)
Berhampore Division -I

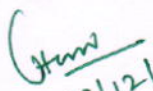
19/12/2018
Block Medical Officer of Health
Anupnagar B. P. H. C.
Dhuliyan, Murshidabad

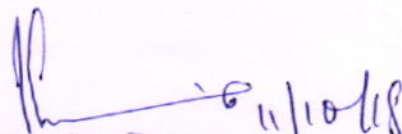
11/10/18
Superntending Engineer
Central Circle, P.W.D.
Berhampore

12/12/18
Chief Medical Officer of Health
Murshidabad

GOVERNMENT OF WEST BENGAL
HEALTH & FAMILY WELFARE DEPARTMENT
NATIONAL HEALTH MISSION (NHM)
GN -29, 1ST FLOOR, GRANTHAGAR BHAWAN,
SWASTHYA BHAWAN PREMISES, SECTOR -V
SALT LAKE, BIDHANNAGAR, KOLKATA - 700 091.

033 - 2357 - 7928, 033 - 2357 - 7930,

Email ID: ponrhmbhealth@gmail.com; website: www.wbhealth.gov.in

No. HFW/NRHM-342/2016/(5184)/2815(1)

Dated. 29.05.2018

From : Programme Officer &
Joint Secretary to the Government of West Bengal,
Health & Family Welfare Department

To : CMOH, Murshidabad.

Sub : Draft drawing of the proposed Mother & Child Hub at Anupnager Block Primary Health Centre of Murshidabad District: Endorsement thereof.

Sir,

Ap[ro]pos the captioned subject, enclosed please find herewith the draft architectural drawing for the proposed 'Mother & Child Hub at Anupnager Block Primary Health Centre.' The drawing has been prepared by West Bengal Medical Service Corporation Limited based on the service areas and number of beds required as suggested by you. Please go through the drawing and revert back with your suggestion/comments within 08th June 2018.

Please treat this as urgent.

Yours faithfully,

Shankar
29/05/18
Programme Officer

&Joint Secretary to the Government of West Bengal,
Health & Family Welfare Department

No. HFW/NRHM-342/2016/(5184)/2815(1)/1(5)

Dated. 29.05.2018

Copy forwarded for kind information to:

1. Managing Director, WBMSCL & Secretary, Health & Family Welfare Department.
2. District Magistrate, Murshidabad.
3. Assistant Engineer, DPMU, Murshidabad
4. Deepak Debnath, SPMU, National Health Mission.
5. Senior P.S to Mission Director, NHM & Secretary, Health & Family Welfare Department

Shankar
29/05/18
Programme Officer

&Joint Secretary to the Government of West Bengal,
Health & Family Welfare Department

Government of West Bengal
Office of the Chief Medical Officer of Health
Murshidabad

(171)

O/c

Memo No: - CM / Msd / Dev- 4902

Dated- Berhampore, the 4th, June'2018

To
The Executive Engineer, PWD
Berhampore Division No-I,
Berhampore, Murshidabad
&
The Executive Engineer, PWD
Murshidabad Electrical Division
Berhampore, Murshidabad

Sub: - Request for submission of Estimate- for setting up of Mother & Child Hub at the premises of Anupnagar BPHC, Samsanganj Block, Murshidabad.

Ref :- Order by Programme Officer, NHM (Vide No- HFW/NRHM-342/2016/5184/2815(1), dt. 29.05.2018

Respected Sir,

Apropos the captioned subject & reference this is to inform you that the Architectural Drawing (G +3) has been received from state and send to your kind end regarding setting up of Mother & Child Hub at the premises of Anupnagar BPHC, Samsanganj Block, Murshidabad.

In this context you are hereby requested to take necessary measures and please be sent the Estimate to the Office of the undersigned as early as possible.

Here the proposed building may be (G +3), but foundation to be taken (G + 5) as directed by the Programme Officer, NHM, Swasthya Bhawan.

Your co-operation in this matter is highly solicited.

With Best regards,

Encl :- i) Proposed Plan

ii) Schedule of Finishes

Yours Faithfully,

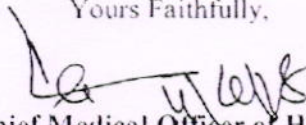

Chief Medical Officer of Health
Murshidabad

Memo No: - CM / Msd / Dev- 4902(2)(1/11)

Dated- Berhampore, the 4th, June'2018

Copy forwarder for information and take necessary action to:-

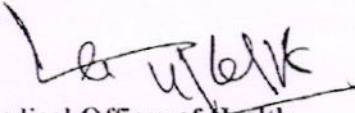
1. The Director of Health Services, Swasthya Bhawan.
2. The Mission Director, NHM, Swasthya Bhawan
3. The Addl. Mission Director, NHM, Swasthya Bhawan.
4. The District Magistrate, Murshidabad.
5. Addl. District Magistrate(LR), Murshidabad.
6. The Dy CMOH-I, Murshidabad
7. The Programme Officer, NHM, Swasthya Bhawan.
8. The O.C(Health), Murshidabad.
9. The Sub Divisional Officer, Jangipur Sub Division, Jangipur
10. The Assistant Engineer, PWD, Jangipur Sub Division, Jangipur
11. The BMOH, Anupnagar BPHC.

Chief Medical Officer of Health
Murshidabad

(6)

No. : 717
Date : 09/08/2018

Minutes of 4th Meeting of State Project Screening Committee for building Projects (SPSCB) under P.W.D. held on 07.08.2018 at 01.00 p.m. at P.W.D., conference Hall, 8th floor, Nabanna, Howrah.

The following officers were present :-

- 1) The Principal Secretary, P.W.D. Govt. of West Bengal
- 2) The Engineer-in-Chief & Ex-officio Secretary, P.W.D. Govt. of West Bengal.
- 3) The Chief Engineer (H.Q.) P.W.D. West Bengal.
- 4) The Chief Engineer (South Zone) P.W.D. West Bengal.
- 5) The Chief Engineer (Social Sector) P.W.D. West Bengal.
- 6) The Chief Engineer (Planning) P.W.D. West Bengal.
- 7) The Chief Engineer Electrical Planning, P.W.D. West Bengal.
- 8) The Chief Engineer Electrical, P.W.D. West Bengal.
- 9) The Superintending Engineer, Bidhannagar Circle, P.W.D. West Bengal.
- 10) The Superintending Engineer, Kolkata Health Circle, P.W.D. West Bengal.
- 11) The Superintending Engineer, Central Circle, P.W.D. West Bengal.
- 12) The Superintending Architect, Social Sector, P.W.D. West Bengal.
- 13) The Superintending Architect, West Zone, P.W.D. West Bengal.
- 14) The Superintending Engineer, Health Electrical Circle, P.W.D. West Bengal.
- 15) The Superintending Engineer, Kolkata Electrical Circle, P.W.D. West Bengal.
- 16) The Superintending Engineer, Central Electrical Circle, P.W.D. West Bengal.
- 17) The Superintending Engineer, Survey & Design Circle, P.W.D. Govt. of West Bengal.
- 18) The Executive Engineer, Kolkata Central Health Division, P.W.D. West Bengal.
- 19) The Executive Engineer, Bidhannagar East Division, P.W.D. West Bengal.
- 20) The Executive Engineer-I, Berhampore Division, P.W.D. West Bengal.
- 21) The Executive Engineer-II, Berhampore Division, P.W.D. West Bengal.
- 22) The Executive Engineer, Nadia Division, P.W.D. West Bengal.
- 23) The Executive Engineer, Central Kolkata Health Electrical Division, P.W.D. West Bengal.
- 24) The Executive Engineer, Bidhannagar Electrical, P.W.D. West Bengal.
- 25) The Executive Engineer, Murshidabad Electrical Division, P.W.D. West Bengal.
- 26) The Executive Engineer, Nadia Electrical Division, P.W.D. West Bengal.
- 27) Mr. D.P. Biswas, Member of the Safety Cell.
- 28) Mr. P.Dey, Member of the Safety Cell.
- 29) Sri Biswajit Dey, Assistant Architect, P.W.D. West Bengal.

*To the extent
for information
and n.a. W
AE/Jangipur
K. take n.a.
for SL no 0203*

The following observations were noted during thread bare discussion on the Projects mentioned below, which are needed to be complied with, prior to approval :

1. **Proposed Mother & Child Hub at Anup Nagar, District-Murshidabad.**
The building project is approved by the Screening Committee with some modifications like spacious entrance lobby, sufficient waiting area, Trolley Bay, Ambulance Dropping zone and widened drive way which may be reviewed from the Health Department end. Hence Clearance Certificate may be issued.
2. **Proposed Stadium at Tehatta.**
One gallery may be planned in the longitudinal direction for better spectator view.
3. **Proposed G+3 storied 200 beded Nursing Girl's Hostel at Jangipur Sub-Division Hospital, Murshidabad.**
The building project is approved by the Screening Committee with minor modifications. Hence Clearance Certificate may be issued.

Contd. 1/2

(7)



GOVERNMENT OF WEST BENGAL
PUBLIC WORKS DEPARTMENT
OFFICE OF THE CHIEF GOVT. ARCHITECT & EX-OFFICIO CHIEF ENGINEER, P.W.D., WEST BENGAL
BHABANI BHAWAN, (NEW BUILDING), 7TH FLOOR, 31/1 BELVEDERE ROAD, KOLKATA 700 027.
Email : cgapudub@gmail.com & cgapudub201@yahoo.com
TEL. - (033) 2448 - 5029
FAX. - (033) 2448 - 5028

No. : _____
Date : _____ (2)

4. Proposed new Judicial-cum-⁶residential Court Complex at Bidhannagar, Kolkata.
The modified building plan to be approved by the Judicial Department. The building project is approved by the Screening Committee. Hence Clearance Certificate may be issued.
5. Proposed Jhargram University.
The project is approved by the Screening Committee
6. G+4 storied Utility block building with one tire basement at Calcutta National Medical College & Hospital.
The observation as raised in the Screening Committee has been complied with. Hence Clearance Certificate may be issued.

The meeting ended with vote of thanks.

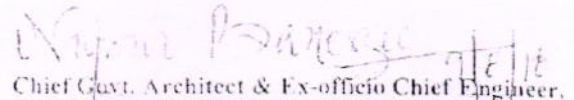
Chief Govt. Architect & Ex-officio Chief Engineer,
P.W.D. Govt. of West Bengal.

Memo No.: 717/1 (29)
Copy to :-

Date: 09/08/2018

- 1) The Principal Secretary, P.W.D. Govt. of West Bengal.
- 2) The Engineer-in-Chief & Ex-officio Secretary, P.W.D. Govt. of West Bengal.
- 3) The Chief Engineer (H.Q.) P.W.D. West Bengal.
- 4) The Chief Engineer (South Zone) P.W.D. West Bengal.
- 5) The Chief Engineer (Social Sector) P.W.D. West Bengal.
- 6) The Chief Engineer (Planning) P.W.D. West Bengal.
- 7) The Chief Engineer Electrical Planning, P.W.D. West Bengal.
- 8) The Chief Engineer Electrical, P.W.D. West Bengal.
- 9) The Superintending Engineer, Bidhannagar Circle, P.W.D. West Bengal
- 10) The Superintending Engineer, Kolkata Health Circle, P.W.D. West Bengal.
- 11) The Superintending Engineer, Central Circle, P.W.D. West Bengal.
- 12) The Superintending Architect, Social Sector, P.W.D. West Bengal.
- 13) The Superintending Architect, West Zone, P.W.D. West Bengal
- 14) The Superintending Engineer, Health Electrical Circle, P.W.D. West Bengal.
- 15) The Superintending Engineer, Kolkata Electrical Circle, P.W.D. West Bengal
- 16) The Superintending Engineer, Central Electrical Circle, P.W.D. West Bengal
- 17) The Superintending Engineer, Survey & Design Circle, P.W.D. Govt. of West Bengal.
- 18) The Executive Engineer, Kolkata Central Health Division, P.W.D. West Bengal
- 19) The Executive Engineer, Bidhannagar East Division, P.W.D. West Bengal.
- 20) The Executive Engineer-I, Berhampore Division, P.W.D. West Bengal.
- 21) The Executive Engineer-II, Berhampore Division, P.W.D. West Bengal.
- 22) The Executive Engineer, Nadia Division, P.W.D. West Bengal.
- 23) The Executive Engineer, Central Kolkata Health Electrical Division, P.W.D. West Bengal.
- 24) The Executive Engineer, Bidhannagar Electrical, P.W.D. West Bengal.
- 25) The Executive Engineer, Murshidabad Electrical Division, P.W.D. West Bengal.
- 26) The Executive Engineer, Nadia Electrical Division, P.W.D. West Bengal.
- 27) Mr. D.P. Biswas, Member of the Safety Cell.
- 28) Mr. P.Dey, Member of the Safety Cell.
- 29) Sri Biswajit Dey, Assistant Architect, P.W.D. West Bengal.

Chief Govt. Architect & Ex-officio Chief Engineer,
P.W.D. Govt. of West Bengal.

STANDARD FORMAT:

Standard format for submission of Rough cost estimate for Setting up of Mother and Child Hub at the premises of Anupnagar BPHC, Samsorganj Block, Murshidabad during the year 2018-19.

1. **NAME OF WORK:** : Proposed Construction of G+3 Storied Mother and Child Hub at the premises of Anupnagar BPHC, Samsorganj Block, Murshidabad during the year 2018-19(Foundation to be taken G+5)
2. **Ref. of Requisition** : Memo no CM/MSD/Dev-4902 dated Berhampore, 4th June 2018 of Chief Medical Officer Of Helth, Murshidabad, and order of the Programme Officer, NHM(Vide No-HFW/NRHM-342/2016/5184/2815(1), dt.29.05.2018
3. **C.G.A Drawing No.** : Drawing supplied by WEST BENGAL MEDICAL SERVICES CORPORATION LTD.
4. **Land whether available:**
 - a) Whether land is free from existing structure : Yes
 - b) Free from sweer line and underground drainage : Yes
 - c) if old structure, any provision in this estimate making land free : No.
5. **Type of soil at foundation:**
 - a) Whether nature of soil built-up. : Yes
 - b) Crack : No.
6. **Type of structure and No. of storied.** : R.C.C frame structure with 4 (four) storied. (provision of Vertical Expansion.)
7. **Rate of volumetric content assumed.** : Rate of volumetric content assumed vide Memo No. 1029/CE(HQ) /PWD dated 09.07.2014 for R.C. Frame Structure Rs. 3250.00/m³
8. **Type of foundation** : R.C.C Pile founding
9. **Cost of Extended Electrification and transformer etc. for competent authority for electrical wings.** : Rs.

10. Approximate quantity of steel and cement used for this structure : Steel 10% of structural cost, cement 12% of structural cost.
11. Cost of service charge to paid to:
a) Corporation :- Nil
b) Municipality : Nil
c) Electrical authority
d) Others :- Nil
12. Cost of Quality Control : 1% of total cost.
13. Time of completion : 2 years (approx)
14. Source of fund along with copy of G.O. : Yet to obtain.

Junior Engineer, PWD
Jangipur Sub-Division
Section-III

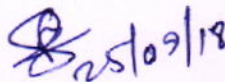
Assistant Engineer, PWD
Jangipur Sub-Division

Executive Engineer
Berhampore Division No.I, PWD

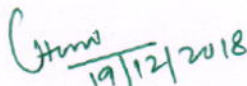
Block Medical Officer of Health
Anupnagar B. P. H. C.
Dhuliyari, Murshidabad

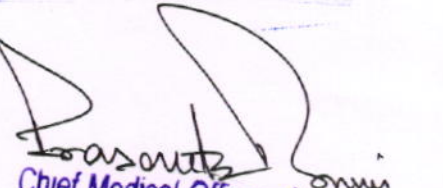
Chief Medical Officer of Health
Murshidabad

PRELIMINARY COST ESTIMATE ON THE BASIS OF VOLUMETRIC CONTENT:

Volumetric Rate for preparation of Preliminary Cost Estimate for the work of -
Proposed Construction of G+3 Storied Mother and Child Hub (Foundation to be taken G+5) at the premises of Anupnagar BPHC, Samsanganj Block, Murshidabad during the year 2018-19

Ref. Order No. of Volumetric Rate: Memo No. 1029/CE(HQ) /PWD dated 09.07.2014
Procedure for calculation of volume of building structure for determine of preliminary cost:

a) Plinth Area of Ground floor (Ag) : = 1272 Sq.m. (from Drg.)
Height of Building upto gr floor roof(Hg) = 1/2 of foundation + plinth ht + story ht
= 1/2 x 1.8 m + 0.6 m + 3.90 + 0.1m = 5.5 m. *5.20m ✓*
1.2
Volume of the building upto Gr floor roof slab (Vg) = Ag x Hg = 1272 x 5.5 = *6996.0 Cum* *6619.40 ✓*

Area of 1st floor (Af) = 1272 sqm
Height of Building upto 1st floor roof(Hf) = 3.60 m
Volume of the building upto 1st floor roof slab (Vf) = Af x Hf = 1272 x 3.60 = 4579.2 Cum

Plinth Area of 2nd floor (Ad) = 1272 sqm
Height of Building upto 2nd floor roof(Hf) = 3.60 m
Volume of the building upto 2nd floor roof slab (Vd) = Ad x Hd = 1272 x 3.60 = 4579.2 Cum

Plinth Area of 3rd floor (Ar) = 960sqm
Height of Building upto 3rd floor roof(Hr) = 3.60 m
Volume of the building upto 3rd floor roof slab (Vr) = Ar x Hr = 960 x 3.60 = 3456.00 Cum

Area for stairs = 2 X 4.0 X 6.4 = 51.2
Height of mummy room = 3.0 m
Volume of stair (Vs) = 51.20 x 3.0 = 153.6 Cum

Area for stairs = 1x6.8x6.4=43.52 sqm
Height of mummy room = 3.0 m
Volume of stair (Vs) = 43.52 x 3.0 = 130.56 Cum

Area of lifts = 3x4.20x3.00= 37.8 sqm
Height of lift room above roof = 4.5 m
Volume of the building in lift over roof (Va) = 37.8x4.5 = 170.10 Cum

Total volume of the Building (V) =
6232.80 + 4579.20 + 4579.20 + 3456.00 + 153.6 + 130.56 + 170.10 = *20064.66 Cum* *(19683.06) ✓*
6619.40

1. Structural cost for R.C.C framed structure
For *19683.06* m³ volume @ 3250 / m³ = Rs. *(63969945.00) ✓*
20064.66 = Rs. *6,52,10,145.00 (A)*

2. Internal Sanitary & Plumbing work 15% of structural cost marked as (A) = Rs. *(9595492.00) ✓*
97,81,522.00

(P-1)

3. Internal Electrification charge ~~20% of structural cost marked as (A) = Rs. 1,30,42,029.00~~

Total volume of building (G+5) = $(\frac{1}{2} \text{ of } 1.8 + 0.6 + 3.9 + 0.1) \times 1272 + (\frac{2}{5} \times 3.6 \times 1272)$

+ (153.6 + 130.56 + 170.10) = ~~31877.16~~ cum. + $3 \times 960 \cdot 00 \times 3.60 = (6614.40 + 9158.40 + 454.26 + 10368.00) = (26595.06)$ Cum.m³

Structural cost for (G+5) = ~~31877.16~~ cum @ 3250.0 = ~~103600770.00~~ (B)

The total volume of building considering (G+5)

Volume of the building upto Gr floor roof slab (Vg1) = Ag x Hg = 1272 x 5.5 = ~~6996.0~~ Cum

Volume of the building from round floor roof to 5th floor roof slab (Vg2)

= 5 nos @ (Ag x Hg) = 5 x 1272 x 3.6 = ~~22896.00~~ cum

Total volume = (Vg1 + Vg2) = ~~6,996.00 + 22,896.00 = 29,892.00~~ cum

Structural cost for R.C.C framed structure (G+5) = ~~29,892.00~~ cum @ 3250 / m³ = Rs. ~~9,70,19,000.00~~ (B)

= For ~~29,892.00~~ cum volume @ 3250 / m³ = Rs. ~~9,70,19,000.00~~ (B)

4. Cost for Pile foundation @ 40% of Structural cost marked as (B)

= Rs. ~~3,88,59,600.00~~

5. Add extra cost for protective and decorative texture

Exterior Acrylic emulsion paint instead including primer instead of cement based paint

Circumferential area of Building =

$2 \times (72.325 + 21.00) \times 17.40 = 3247.71$ sqm

Extra area for stair mumty room $2 \times 2(4.0 + 6.4) \times 3.0 = 124.80$ sqm

Extra area for stair mumty room $1 \times 2(6.8 + 6.4) \times 3.0 = 79.20$ sqm

Extra area for lift machine room $3 \times 2(4.2 + 3.0) \times 4.5 = 194.40$ sqm

Total Circumferential area of Building = $3247.71 + 124.80 + 79.20 + 194.40 = 3646.11$ sqm.

Difference in unit cost = (Rs 3247 + Rs 8507 - Rs 5007.00) / %sqm

= 6747.00 / %sqm

{ vide page 196, it no 8(a), page 197, it no 17(b) & it 15(iii) page 197 }

Rate taken for (avg.) of all floor.

Hence additional cost involved for exterior acrylic emulsion

= $3646.11 \text{ sq m} \times \text{Rs } 6747.00 / \% \text{ sqm} = 246,003.00$

Rate including 12% GST & 1% CESS

= Rs. ~~2,78,278.00~~

6. Add extra for in Vitrified floor instead of A.S.F

Total floor area of Building = $3 \times 1272 + 960 = 4776.00$ sqm

Difference in unit cost = (Rs 1692.50 - Rs 326.18) / sqm = Rs. 1366.32 / sq. m

(P-2)

{ vide page 66, it no 36(i) (b), page 48, it no 6(ii)}

Rate taken for all floor.

Hence additional cost involved $4776.0 \times 1366.32 = 65,25,544.00$

Rate including 12% GST & 1% CESS = Rs 73,81696.00

7. Add extra for putty work solvent based primer & acrylic distemper over internal walls instead of white wash above 2.10m height and ceiling

Total ceiling area of Building = $(3 \times 1272) + 960 = 4776.00$ sqm

ceiling area stair mumty room & lift machine room

$= (2 \times 4.0 \times 6.4) + (1 \times 6.8 \times 6.4) + (3 \times 4.20 \times 3.00) = 132.52$ sqm.

Total ceiling area = 4776.00 sqm + 132.52 sqm. = 4908.52 sqm.

Internal wall area above 2.10m height

Ground floor = $1004.68 \text{ M} \times 1.40 \text{ m} = 1406.6$ sqm

1st floor = $913.2 \text{ M} \times 1.40 \text{ m} = 1278.48$ sqm

2nd floor = $604.4 \text{ M} \times 1.40 \text{ m} = 846.16$ sqm

3rd floor = $432.0 \text{ M} \times 1.40 \text{ m} = 604.80$ sqm

4th floor mumty & lift room = $70.8 \text{ M} \times 3.0 \text{ m} = 212.40$ sqm

Total area of painting = $4908.52 + 1406.6 + 1278.48 + 846.16 + 604.8 + 212.4 = 9256.97$ sqm

Difference in unit cost =

{ Rs 122.00 + Rs 70.00 - Rs 20.01 } sq m

= Rs 171.99 / sqm

{ vide page 198, it no 5, page 196, it no 10, page 194, it no 1 }

Rate taken for 2nd floor (avg.)

Hence additional cost involved for exterior acrylic emulsion

$= 9256.97 \times 171.99 / \text{sqm} = 15,92,106.00$

Rate including 12% GST & 1% CESS

= Rs 18,00,990.00

8. Add extra for Double charged Vitrified tiles work in vertical wall up to 2.1m height,

Internal wall area up to 2.10m height

Ground floor = $1004.68 \text{ M} \times 2.1 \text{ m} = 2110.08$ sqm

1st floor = $913.2 \text{ M} \times 2.1 \text{ m} = 1917.72$ sqm

2nd floor = $604.4 \text{ M} \times 2.1 \text{ m} = 1269.24$ sqm

3rd floor = $432.0 \text{ M} \times 2.1 \text{ m} = 907.20$ sqm

Total area of wall Vitrified = $2110.08 + 1917.72 + 1269.24 + 907.20 = 6204.24$ sqm

Difference in unit cost =

(P-3)

294600
{ Rs 295400 - Rs 2001 } / %sq m
= Rs 293399 / %sqm

{ vide page 70, it no 42 (b), page 194, it no 1 }

Rate taken for 2nd floor (avg.)

Hence additional cost involved for exterior acrylic emulsion

= ~~6204.24 x 293399.00 / % sqm = 1,82,03,178.00~~ 18152813.00

Rate including 12% GST & 1% CESS

(20534462.00) ✓
= Rs 2,05,91,435.00

9. Add extra for *Stainless Steel railing*

Total length of railing = 3x33.20 m =99.60 sqm

@ cost = 9077.00 per m

{ vide page 109, it no 22 (b)}

Hence additional cost involved for ~~exterior acrylic emulsion~~

= 99.6 x 9077.0m =9,04,069.00

Rate including 12% GST & 1% CESS

= Rs 10,22,683.00

10. Add extra cost fire fighting and fire safety

Total floor area of building = 3 x1272 +960 =4776.00 sqm

907.50 (4334220.00) ✓
@ 852.50 / sqm = Rs 40,71,540.00

11. Add extra cost for soil investigation L.S.

1.0% of structural cost marked as (A) = 6,52,10,145.00 x0.01

(300,000.00) ✓
=Rs. 6,52,101.00

12. Cost of Land Development including (P-6)

12%GST, 1% CESS & 3% CONTIGENCY

= Rs 5,23,934.00

13. Cost of Boundary wall (P-7 to 11)

12%GST, 1% CESS & 3% CONTIGENCY

(1860305.00) ✓
= Rs 18,53,727.00

14. Sinking of Tube well (P-12-13)

12%GST, 1% CESS & 3% CONTIGENCY

(230353.00) ✓
= Rs 2,59,742.00

(P-4)

15. Cost of Compound Road (P-14 to 16)

12%GST, 1% CESS & 3% CONTIGENCY

= Rs. 88,57,098.00

Rs. (97,58,454.00) ✓

16. Cost of Drain & Plinth Protection (P-17 to 19)

12%GST, 1% CESS & 3% CONTIGENCY

= Rs. 10,94,836.00

(10,88,103.00) ✓

17. Cost of Underground Reservoir (P-20 to 24)

12%GST, 1% CESS & 3% CONTIGENCY

= Rs. 16,12,242.00

(16,03,332.00) ✓

18. Cost of Horticulture work (P-25 to 26)

12%GST, 1% CESS & 3% CONTIGENCY

= Rs. 7,13,104.00

19. Cost of Electrical Sub-station (P-27 to 38)

12%GST, 1% CESS & 3% CONTIGENCY

= Rs. 46,79,665.00

(52,34,842.00) ✓

20. Cost of Pump room (P-39-43)

12%GST, 1% CESS & 3% CONTIGENCY

= Rs. 3,52,840.00

(3,70,388.00) ✓

21. Cost of 125KV D.G Shed (P-44 to 46)

12%GST, 1% CESS & 3% CONTIGENCY

= Rs. 2,58,865.00

(2,58,936.00) ✓

TOTAL

= Rs. 18,28,98,072.00

22. Electrical Works = Rs. 4,71,42,979/-
(P-1 to 3)
Sl.-22

Civil Amount = 16,54,33,095.00
Electrical Amount = Rs. 4,68,99,999.00
Total = Rs. 21,23,32,803.00
Rs. 21,25,76,074.00

Civil Amount - 16,54,33,095.00
Electrical Amount @ 4,71,42,979.00
Rs. 21,25,76,074.00

28/09/18

Assistant Engineer PWD
Jangipur Sub-Division

Executive Engineer
Berhampore Division No.I, PWD

Estimate Vetted

Less 3% contingency (-) 63,77,282.22

Rs. 20,61,98,791.78

(P-5)

Add 4.72% administrative charges of WBMSCL say Rs. 21,59,31,375.00
Rs. 21,59,31,374.75

Superintending Engineer
Central Circle, P.W.D
Berhampore

ESTIMATE VETTED
VETTED AMOUNT STANDS FOR
Rs. 2125.76 Lakh.
15/12/2018

Estimate Vetted
Chief Engineer, South Zone
Public Works Directorate
Govt. of West Bengal

Assistant Engineer (Civil)
West Bengal Medical Services Corporation Ltd.

Consultant Eng. (Elect.)
West Bengal Medical Services Corporation Ltd.

Consultant Project Eng. (Civil)
West Bengal Medical Services Corporation Ltd.

Block Medical Officer of Health
Anupnagar B. P. H. C.
Dhuliyan, Murshidabad

Chief Medical Officer of Health
Murshidabad

P.T.O.

(15)

Amount of civil works. ————— Rs. 16,54,33,095.00

Less 3% contingency ————— Rs. 49,62,993.00

Rs. 16,04,70,102.00

Add 4.72% administrative
charges of WBMSC.

Rs. 75,74,189.00

Rs. 16,80,44,291.00

Asst. Eng.
29/12/18

Consultant Project Eng. (Civil)
West Bengal Medical Services Corporation Ltd.

Amount of Electrical works ————— Rs. 4,71,42,979

Less 3% contingency ————— Rs. 14,14,289

Rs. 4,57,28,690

Add 4.72% administrative
charges of WBMSC

Rs. 21,58,394

Rs. 4,78,87,084

Asst. Eng.
8/1/19

Consultant Eng. (Elect.)
West Bengal Medical Services Corporation Ltd.

Estimate VETTED

ESTIMATE VETTED
VETTED AMOUNT STANDS FOR

Chief Engineer, PWD
Govt. of West Bengal

Chief Engineer (Civil)
West Bengal Medical Services Corporation Ltd.

Chief Medical Officer of Health

(SL NO - 12)

Land Development for Proposed Construction of of G+3 Storied Mother and Child Hub at the premises of Anupnagar BPHC, Samserganj Block, Murshidabad during the year 2018-19(Foundation to be taken G+5)

Total Area of land =90.00m x40m =3600.00 sq.m,

1 P-268/item-19

Clearing compound premises of shrubs, plants, jungles etc. by cutting and removing as directed (Specific permission of Engineer-in-Charge prior to execution will be necessary). (Payment to be made on area cleared)

$$90.0 \times 40.00 = \frac{3600.00}{3600.00} \text{ m}^2$$

@ Rs. 11.00 / sq.m = Rs. 39600.00

2 P-2/item-5 (b) (ii)

Earth work in filling in compound, tank, low land, ditches etc. with good earth, in layers not exceeding 150 mm. including breaking clods and consolidating the same by ramming and dressing complete. (Payment will be made on profile easurement before and after the work)

(ii) With carried earth arranged by the contractor within a radius ~~exceeding 3 km. but not exceeding 5 km. including the cost of~~ carried earth

$$90.00 \times 40.0 \times 0.30 = \frac{1080.00}{1080.00} \text{ m}^3$$

@ Rs. 37982.00 / %cum = Rs. 410206.00

Total (A)= 449806.00

Add 12% GST on "A", (B)= 53977.00

Cost of civil work excluding cess (C),SUM OF "A+B"= 503783.00

Add 1% cess on (C), D= 5038.00

Cost of civil work including cess (E),SUM OF "C+D"= 508821.00

Add 3% contingency on (C)= 15113.00

GRAND TOTAL= 523934.00

[Signature]
25-09-18
Junior Engineer, Sec-III PWD,
Jangipur Sub-Division

[Signature]
25/09/18
Assistant Engineer PWD Jangipur
Sub-Division

[Signature]
21/10/18
Executive Engineer
Berhampore Division No.I, PWD

[Signature]
Chief Medical Officer of Health
Murshidabad

(P-5)

(SL NO - 13)

Construction of Boundary wall with concertina barbed wire for Proposed Construction of G+3 Storied Mother and Child Hub at the premises of Anupnagar BPHC, Samserganj Block, Murshidabad during the year 2018-19 (Foundation to be taken G+5).

Length of Boundary Wall to be constructed = 100.0m + 55.0m = 155.00m (only two side of boundary wall is considered because other two side is existing)

No. of column @ 2.50m c/c = 155.0 / 2.5 = 62

No. of expansion joint = 8

1 P-1/item-2

Earth work in excavation of foundation trenches or drains, in all sorts of soil (including mixed soil but excluding laterite or sandstone) including removing, spreading or stacking the spoils within a lead of 75 m. as directed. The item includes necessary trimming the sides of trenches, levelling, dressing and ramming the bottom, bailing out water as required complete.

a) depth of excavation not exceeding 1500mm

for single column	62	x	1.00	x	1.0	x	1.50	=	93.00	m ³
for twin column	8	x	1.50	x	1.0	x	1.50	=	18.00	m ³

Tie beam 1 x 85.00 x 0.35 x 0.45 = 13.04

~~11.00~~
125.00

@ Rs. 11927.00 / %cum

Rs.

(14909.00)^m
~~13239.00~~

2 P-2/item-4(B)

Filling in foundation or plinth by silver sand in layers not exceeding 150 mm as directed and consolidating the same by thorough saturation with water, ramming complete including the cost of supply of sand. (payment to be made on measurement of finished quantity)

b) do by fine sand

for single column	62	x	1.00	x	1.0	x	0.30	=	18.60	m ³
for twin column	8	x	1.50	x	1.0	x	0.30	=	3.60	m ³

Qty. = 22.20 m³

@ Rs. 71181.00 / %cum

Rs.

15802.00

3 P-47/item-3

Supplying and laying Polythene Sheet (150gm / sq.m.) over damp proof course or below flooring or roof terracing or in foundation or in foundation trenches.

for single column	62	x	1.00	x	1.00	x	1	=	62.00	m ²
for twin column	8	x	1.50	x	1.00	x	1	=	12.00	m ²
for Tie Beam	1	x	155.00	x	0.25	x	0.35	=	54.25	m ²
deducts columns	70	x	0.25	x	0.25	x	1	=	-4.38	m ²

~~108.38~~
123.87

@ Rs. 24.00 / sq.m

Rs.

(2973.00)^m
~~2601.00~~

4 P-34/item-22

(I) Cement concrete with graded stone ballast (40 mm size excluding shuttering) In ground floor

(a) 1:3:6 proportion

for single column	62	x	1.00	x	1.0	x	0.1	=	6.20	m ³
for twin column	8	x	1.50	x	1.0	x	0.1	=	1.20	m ³
for Tie Beam	1	x	155.00	x	0.35	x	0.1	=	5.43	m ³
deducts columns	70	x	0.25	x	0.25	x	0.1	=	-0.44	m ³

Qty. = 12.39 m³

@ Rs. 5188.93 / cum

Rs.

(64291.00)^m
~~64278.00~~

(P-7)

5 P-25/item-6

Controlled Cement concrete with well graded stone chips (20 mm nominal size) excluding shuttering and reinforcement with complete design of concrete as per IS : 456 and relevant special publications, submission of job mix formula after preliminary mix design after testing of concrete cubes as per direction of Engineer- in charge. Consumption of cement will not be less than 300 Kg of cement with Super plasticiser per cubic meter of controlled concrete but actual consumption will be determined on the basis of preliminary test and job mix formula. In ground floor and foundation.

[usina concrete mixture]

for Footing	62	x	0.9	x	0.9	x	0.25	=	12.56	m ³
for Footing	8	x	1.4	x	0.9	x	0.15	=	7.53	m ³
for tie Beam	1	x	155.00	x	0.25	x	0.35	=	2.52	m ³
for column upto E.G.l	62	x	0.25	x	0.25	x	0.50	=	13.56	m ³
for column upto E.G.l	8	x	0.25	x	0.25	x	0.50	=	1.94	m ³
column Tie beam	62	x	0.25	x	0.25	x	2.53	=	3.08	m ³
top tot op band									0.25	m ³
column Tie beam	8	x	0.25	x	0.25	x	2.53	=	0.48	m ³
top to top band									1.25	m ³
top band	1	x	155.00	x	0.25	x	0.25	=	1.55	m ³
									9.69	m ³
									50.01	m ³

@ Rs 5976.27 / m3 Rs 51.46

(307539.00) ✓
268896.00

6 P-27/item-15

Reinforcement for Reinforced concrete work in all sorts of structure in/c distribution bars, stirrups, binders etc in/c supply of rods initial straightening and removal of loose rust (if necessary) cutting to requisite length, hooking and bending to correct shape, placing in proper position and binding with 16 gauge black annealed wire at every intersection comp as per drawing and direction.

a) for works in foundation, basement and upto roof of g/floor / upto 4m.

i) for steel/mild steel Other than SAIL/TATA/RINL

in ground floor: (@1.5% of concrete volume)

	51.46	x	0.015	=	7.85	6.06	MT
	60.01	x		=	7.85	5.889	MT
	70241.05				Qty.	5.89	MT
@	Rs. 70241.05	/	MT			6.10	

Rs.

(428470.00) ✓
413510.00

7 P-42/item-36

Hire and labour charges for shuttering with centering and necessary staging upto 4 m using approved stout props and thick hard wood planks of approved thickness with required bracing for concrete slabs, beams and columns, lintels curved or straight including fitting, fixing and striking out after completion of works (upto roof of ground floor)

(f) 25 mm to 30 mm shuttering without staging in foundation

for PCC	62	x	4	x	1.00	x	0.1	=	24.80	m ²
for PCC	8	x	2	x	1.00	x	0.1	=	1.60	m ²
for PCC	8	x	2	x	1.50	x	0.1	=	2.40	m ²
for Footing	62	x	4	x	0.90	x	0.15	=	55.80	m ²
for Footing	8	x	2	x	0.90	x	0.15	=	3.6	m ²
for Footing	8	x	2	x	1.40	x	0.15	=	5.6	m ²
for column upto E.G.l	62	x	4	x	0.25	x	0.51	=	31.00	m ²
for column upto E.G.l	8	x	4	x	0.25	x	0.51	=	4.00	m ²
for tie Beam pcc	2	x	155.00	x	0.25	x	0.100	=	7.75	m ²
for tie Beam	1	x	155.00	x	2	x	0.35	=	108.5	m ²
							Qty.	245.05	258.30	m ²

@ Rs. 205.00 / sq.m

Rs.

(50235.00) ✓
52952.00

(c) Steel shuttering or 9 to 12 mm thick approved quality ply board shuttering in any concrete work

column Tie beam	62	x	4	x	0.25	x	2.50	=	155.00	m ²
top to top band							2.75	=	170.50	m ²
column Tie beam	8	x	4	x	0.25	x	2.50	=	20.00	m ²
top to top band							2.75	=	22.00	m ²
top band bottom	1	x	155.00	x	0.125	x	1.00	=	19.38	m ²
top band side	1	x	155.00	x	2	x	0.250	=	77.50	m ²
							Qty.	289.38	258.30	m ²

@ Rs. 365.00 / sq.m

Rs.

(99236.00) ✓
105622.00

(P-8)

8 P-16/item-16

125 mm. thick brick work with 1st class bricks in cement mortar (1:4) in ground floor.

Ground floor

for wall			155.00	x	2.5	=	387.50	m ²
less column	62	x	0.25	x	2.75	=	426.25	m ²
less column	8	x	0.25	x	2.75	=	542.63	m ²
less gate open	1	x	4.00	x	2.75	=	5.50	m ²
							11.00	m ²
							367.13	m ²
							333.75	m ²
@	Rs.		677.00	/	sq.m			Rs.

(225949.00) ✓
248542.00

9 P-189/item-1

Plaster (to wall, floor, ceiling etc.) with sand and cement mortar including rounding off or chamfering corners as directed and raking out joints including throating, nosing and drip course, scaffolding/staging where necessary (Ground floor). [Excluding cost of chipping over concrete surface]

(i) With 1:6 cement mortar

(c) 15 mm thick plaster

For top band

For top band	1	x	155.00	x	0.875	x	1	=	135.63	m ²
For top band top	1	x	155.00	x	0.25	x	1	=	38.75	m ²
for wall	2	x	155.00	x	2.75	=	775.00	m ²		
add for column	70	x	2	x	0.125	x	2.75	=	48.13	m ²
									1075.00	m ²
									993.13	m ²
@	Rs.		142.00	/	m ²					Rs.

(141024.00) ✓
152649.00

10 P-196/item-8

Applying Exterior grade Acrylic primer of approved quality and brand on plastered or concrete surface old or new surface to receive decorative textured (matt finish) or smooth finish acrylic exterior emulsion paint including scraping and preparing the surface thoroughly, complete as per manufacturer's specification and as per direction of the EIC.

in ground floor:

(a) One Coats

For top band	1	x	155.00	x	0.875	x	1	=	135.63	m ²
For top band top	1	x	155.00	x	0.25	x	1	=	38.75	m ²
for wall	2	x	155.00	x	2.75	=	775.00	m ²		
add for column	70	x	2	x	0.125	x	2.75	=	48.13	m ²
									1113.75	m ²
									993.13	m ²
@	Rs.		3140.00	/	%m ²					Rs.

(31189.00) ✓
34972.00

11 P-197/item-17

Protective and Decorative Acrylic exterior emulsion paint of approved quality, as per manufacturer's specification and as per direction of EIC to be applied over acrylic primer as required. The rate includes cost of material, labour, scaffolding and all incidental charges but excluding the cost of primer. in ground floor: (Two coat)

a) Normal Acrylic Emulsion - b) Premium 100% Acrylic Emulsion

									993.13	m ²
@	Rs.		67.00	/	m ²				4113.75	m ²
										Rs.

(83423.00) ✓
74624.00

12 P-104/item-13

(a) M.S. or W.I. Ornamental grill of approved design joints continuously welded with M.S. W.I. Flats and bars of windows, railing etc. fitted and fixed with necessary screws and lugs in ground floor.

(i) Grill weighing above 16 Kg./sq. mtr.

	1	x	4.00	x	3.20	=	12.80	m ²			
	1	x	1.50	x	2.00	=	3.00	m ²			
							15.80	m ²			
									20.00	Kg/m ²	
										316.00	Kg
										3.160	Qntl
@	Rs.		9696.00	/	Qntl					Rs.	

30639.00

(P-9)

13 P-200/item-1

(b) Priming one coat on steel or other metal surface with synthetic oil bound primer of approved quality including smoothing surfaces by sand papering etc.

1	x	4.00	x	3.20	=	12.80	m ²
	x	1.50	x	2.00	=	3.00	m ²
						<u>15.80</u>	m ²

@ Rs 29.00 /m² Rs 458.00

14 P-200/item-23

(B) On steel or other metal surface With ~~super gloss (hi-gloss)~~ *other than hi-gloss of approved quality*
(ii) Two coats (with any shade except white)

= 15.80 m²

@ Rs 72.00 /m² Rs 1138.00

15 P-222/item-13

Supplying fitting and fixing 600 mm (+/- 30mm) diametre R.B.T (Reinforced Barbed Tape) Concertina fencing on wall top using concertina coils stretched to approx.6 meters length at site clipped with two nos. of horizontal R.B.T strands which will be tensioned and fixed with the vertical M.S angle iron posts by means of security fasteners (such as 'C'

For wall	1	x	1	x	100.00	=	100.00	m
	1	x	1	x	55.00	=	55.00	m
					<u>Qty.</u>		<u>155.00</u>	m

@ Rs 408.00 m Rs 63240.00

16 P-100/item-1

M.S. structural works in columns, beams etc. with simple rolled structural members (e.g. joists, angle, channel sections conforming to IS: 226, IS: 808 & SP (6)- 1964 connected to one another with bracket, gussets, cleats as per design, direction of Engineer-in-charge complete including cutting to requisite shape and length, fabrication with necessary bolting, metal arc welding conforming to IS: 816- 1969 & IS: 1995 using electrodes of approved make and brand conforming to IS:814- 2004, haulage, hoisting and erection all complete. The rate includes the cost of rolled steel section, consumables such as electrodes, gas and hire charge of all tools and plants and labour required for the work including all incidental chages such as electricity charges, labour insurance charges etc.

I) For structural members of specified sections weighing not less than 22.5 Kg./m

For concertina	2	x	70	x	0.90	=	126.00	m
Angle 40x40x5mm <i>45x45x6 m.m.</i> @ 4.00Kg/ M					<i>= 509.00 kg.</i>	Qty.	<i>= 0.252</i>	MT
							<i>0.504</i>	MT

@ Rs 72603.00 MT Rs 18296.00

Total (A) = 1591455.00 *1597102.00*

Add 12% GST on "A", (B)= 190975.00 *191652.00*

Cost of civil work excluding cess (C), SUM OF "A+B"= 1782430.00 *1788754.00*

Add 1% cess on (C), D= 17824.00 *17858.00*

Cost of civil work including cess (E), SUM OF "C+D"= 1800254.00 *1806642.00*

Add 3% contingency on (C)= 53473.00 *53663.00*

GRAND TOTAL= Rs. 1853727.00 *1860305.00*

(P-10)

J. Meelick
25.09.18
Junior Engineer, Sec-III PWD,
Jangipur Sub-Division

[Signature]
25/09/18
Assistant Engineer
PWD Jangipur Sub-

GHW
19/12/2018

[Signature]
21/12/18
Executive Engineer
Serhampore Division No.I, PWD

Block Medical Officer of Health
Anupnagar B. P. H. C.
Dhuluiyan, Murshidabad

[Signature]
Chief Medical Officer of Health
Murshidabad
13/12/18

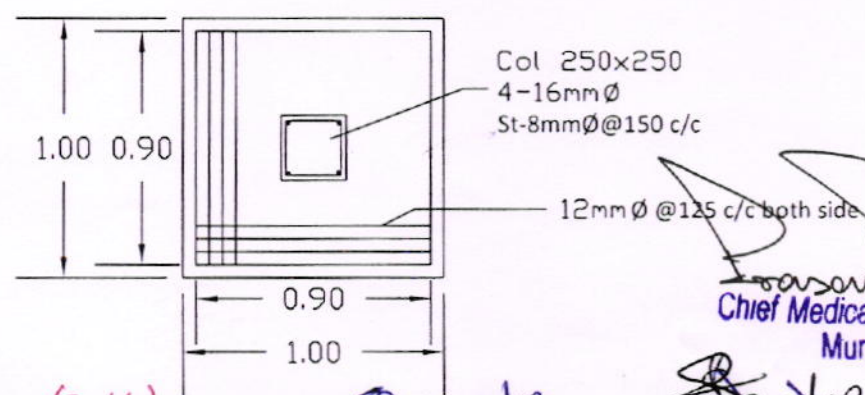
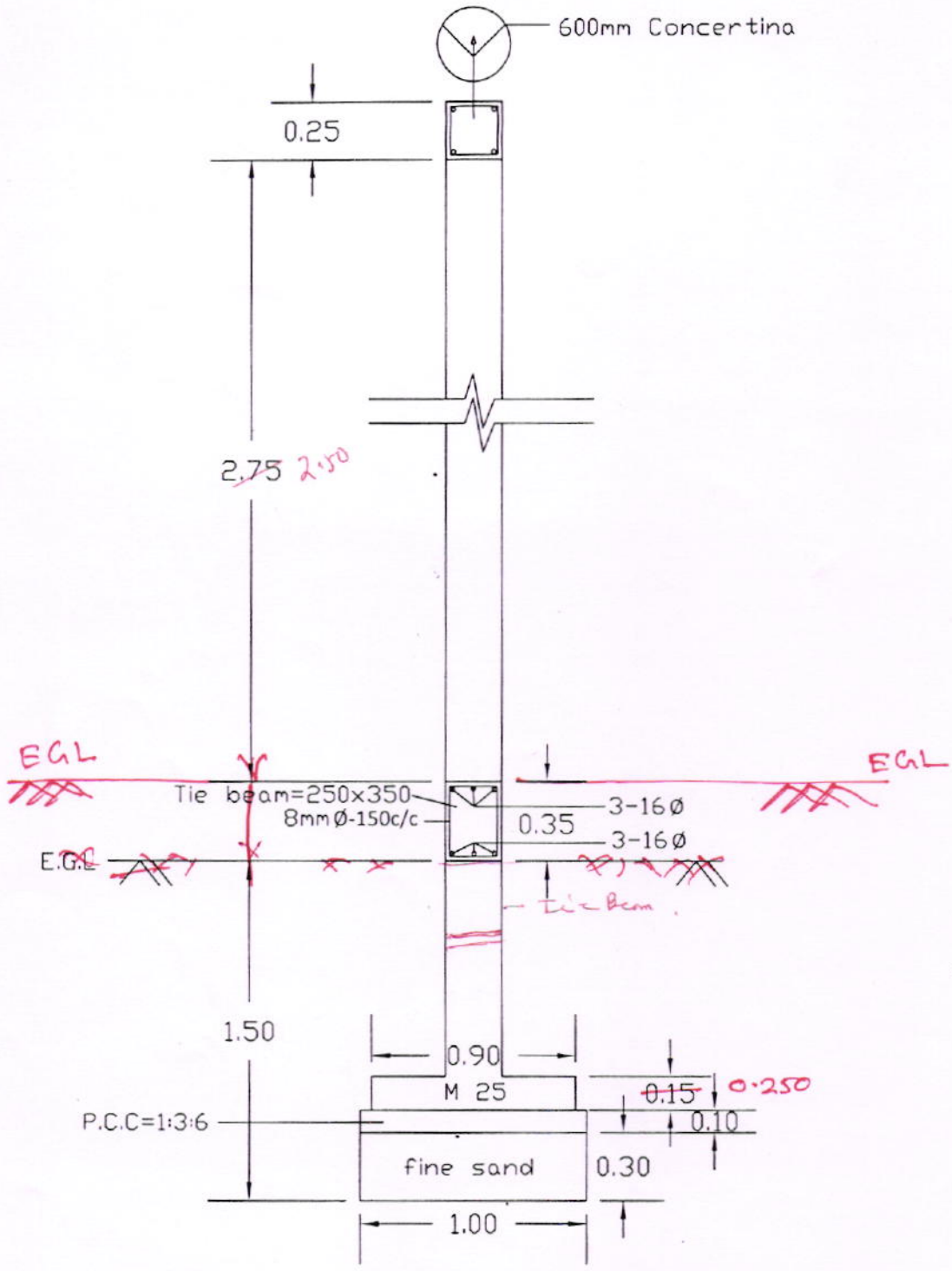

19/12/2018
 Block Medical Officer of Health
 Anupnagar B. P. H. C.
 Dhuliyan, Murshidabad

08-06-18
 (P-11)

08/06/18
 Assistant Engineer PWD
 Jangipur Sub-Division

Chief Medical Officer of Health
 Murshidabad
 08/06/18

(SL NO-14)

Sinking of Tube well for Proposed Construction Proposed Construction of of G+3 Storied Mother and Child Hub at the premises of Anupnagar BPHC, Samserganj Block, Murshidabad during the year 2018-19 (Foundation to be taken G+5)

1 P-49/item-1

e) Labour for boring tube well of required dia. by water jet system through any type of soil strata including hire and labour charges for boring pipes, scaffolding, tools and plants as necessary and taking out them and lowering pipes, strainers, blind pipe etc. and fitting and fixing the same complete including bucket washing and other dental works in the connection. The tube well should have a minimum 50 mm gap in between the outside of the tubewell pipe and the bore.

(i) 80 mm dia	1	x	50.000	x	1.000	x	1.000	=	50.00 m	
	@	Rs.	287.00		m					Rs. 14350.00
(ii) 150 mm dia	1	x	45.000	x	1	x	1	=	45.00 m	
	@	Rs.	685.00		m					Rs. 30825.00

2 P-55/item-20

Washing and developing tube well with air compressor pump and engine for 8 (eight) hours continuous pumping per day with necessary arrangements for testing the yield in gallons per hour with 'V' notch including hire and labour charges for all tools and plants and scaffolding as required.

For 3 days	3	x	1	x	1	x	1	=	3 days	
	@	Rs.	7538.00		days					Rs. 22614.00

3 P-52/item-5

Supplying high density polythene strainer of approved make with adapter conforming to I.S. specifications.

(iii) 80 mm dia	1	x	20.00	x	1	x	1	=	20.00 m	
	@	Rs.	820.00		m					= Rs. 16400.00

4 P-53/item-9

Supplying, fitting and fixing steel cutter piece upto 450 mm long with sockets.

iii) 75 mm dia.					1	x	1	=	1 each	
	@	Rs.	403.00		each					Rs. 403.00

5 P-53/item-10

Supplying, fitting and fixing plug of approved make conforming to I.S. specifications.

iii) 75 mm dia.					1	x	1	=	1 each	
	@	Rs.	130.00		each					Rs. 130.00

6 P-54/item-17

Supplying, fitting and fixing heavy type bell mouth reducing socket.

75mm x150mm					1	x	1	=	1 each	
	@	Rs.	616.00		each					Rs. 616.00

7 P-12/item-49(II) 19 (III)

Supplying, fitting and fixing PVC pipes for underground work of approved make of Schedule 80 (medium duty) conforming to ASTM D - 1785 and threaded to match with GI Pipes as per IS : 1239 (Part - I), with all necessary accessories, specials viz. socket, bend, tee, union, cross, elbo, nipple, long screw, reducing socket, reducing tee, short piece etc. fitted including cost of all materials, jointing materials, cutting pipes, making threads, cutting trenches upto 1.5 metre below surface in all sorts of soil and refilling the same as directed complete in all respect. (Payment will be made on the centre line measurement of the total pipe line including all specials No separate payment will be made for accessories, specials.) PVC Pipes

(i) 80 mm dia	1	x	30	x	1	x	1	=	30.00 m	
	@	Rs.	795.00 578.00		m					= Rs. (17340.00) ✓
(ii) 150 mm dia	1	x	45.000	x	1	x	1	=	45.00 m	
	@	Rs.	1836.00 1420.00		m					= Rs. (63900.00) ✓

8 P-56/item-27

Supplying, fitting and fixing 300 mm M.S. housing clamp of approved quality.

300 mm	2	x	1	x	1	x	1	=	2 each	
	@	Rs.	2235.00		m					= Rs. 4470.00

(P-12)

9 P-54/item-18

Supplying, fitting and fixing G.I. cap at top

ii) 150mm 1 x 1 x 1 x 1 = 1 each
 @ Rs. 503.00 m = Rs. 503.00

10 P-55/item-22

Labour for making arrangement for showing verticality test including the cost for hire charges of tools and plants, cafoolding, labour etc. all complete.

1 x 1 x 1 x 1 = 1 LS
 @ Rs. 916.00 m = Rs. 916.00

11 P-55/item-23

Collecting sample of water for bacteriological and chemical test from any depth at any time during execution of work including hire and labour charges for tools and plants and sterilising the equipments, paying all charges and fees, testing etc. complete in all respect as per direction.

1 x 1 x 1 x 1 = 1 each
 @ Rs. 1231.00 m = Rs. 1231.00

12 P-55/item-24

Packing the annular space between the outside of the tube well pipes & strainers and the bore with pea size washed gravel of approved quality having size from 2 mm to 5 mm or the size approved by the Engineer-in-charge including cost of all materials labour and equipment complete.

1 x 4 x 1 x 1 = 4
 @ Rs. 2029.00 m = Rs. 8116.00

13 P-2/item-1

Supplying, fitting and fixing G.I. pipes of TATA make with all necessary accessories, specials viz. socket, bend, tee, union, cross, elbo, nipple, longscrow, reducing socket, reducing tee, short piece etc. fitted with holder bats clamps, including cutting pipes, making threads, fitting, fixing etc. complete in all respect including cost of all necessary fittings as required, jointing materials and two coats of painting with approved paint in any position above ground. (Payment will be made on the centre line measurements of total pipe line including all specials. No separate payment will be made for accessories, specials. Payment for painting will be made seperately)(A) For Exposed Work (e) (ii) 40 mm dia. medium quality

1 x 30 x 1 x 1 = 30 m
 @ Rs. 415.00 m = Rs. 12450.00

(k) (i) 150 mm dia. medium quality

1 x 1.20 x 1 x 1 = 1.2 m
 @ Rs. 1543.00 m = Rs. 1852.00

14 P-4/item-4

Supplying, fitting and fixing Peet's valve fullway gunmetal standard pattern best quality of approved brand bearing I.S.I. marking with fittings (tested to 21 kg per sq. cm.)

(v) 40 mm dia 1 x 1 x 1 x 1 = 1 each
 @ Rs. 1646.00 each = Rs. 1646.00

B. 222992.00 (197762.00) ✓
 Add 12% GST on "A", (B)= ~~Rs. 26759.00~~ (23731.00) ✓
 of civil work excluding cess (C), SUM OF "A+B"= 249751.00 (221493.00) ✓
 Add 1% cess on (C), D= 2498.00 2215.00 ✓
 t of civil work including cess (E), SUM OF "C+D"= 252249.00 223708.00 ✓
 Add 3% contingency on (C)= 7493.00 6645.00 ✓
 GRAND TOTAL= 259742.00 ~~Rs. (230353.00)~~ ✓

(P-13)

S. S. S. S.
 25-09-18
 Junior Engineer, Sec-III PWD, Jangipur Sub-Division

S. S. S. S.
 25/09/18
 Assistant Engineer PWD Jangipur Sub-Division

Assistant Engineer PWD
 Jangipur Sub-Division

Chaw
 17/12/2018
 Block Medical Officer of Health
 Anupnagar B. P. H. C.
 Dhuluiyan, Murshidabad

S. S. S. S.
 Chief Medical Officer of Health
 Murshidabad

(SL NO - 15)

Construction Of Concrete Road for Proposed Construction of of G+3 Storied Mother and Child Hub at the premises of Anupnagar BPHC, Samserganj Block, Murshidabad during the year 2018-19(Foundation to be taken G+5).

1 P-237 It.-3.16 (R&B)

Box cutting or filling in Road embankment in all sorts of soil including spreading the spoils properly over the flank as necessary or on berm to approximate grade & camber and rolling the sub-grade with power roller to proper camber and grade as per direction and satisfaction of Engineer-in-charge including uprooting and removing plants and jungles when and where necessary. a) Depth up to 150

1	x	84.325	x	7.00	x	2	=	1180.55	m2
1	x	73.00	x	7.00	x	2	=	1022.00	m2
1	x	95.00	x	7.00	x	1	=	665.00	m2
								(A)	2867.55 m2

@ Rs. 14.40 / sq.m Rs. 41293.00

1.1 (b) For each additional Depth of 150mm and part thereof

4	x	84.325	x	7.00	x	2	=	4722.20	m2
4	x	23.00	x	7.00	x	2	=	1288.00	m2
4	x	55.00	x	7.00	x	1	=	1540.00	m2
								(A)	7550.20 m2

@ Rs. 19.00 / sq.m Rs. 143454.00

2 P-243 It.-4.08/ B(R&B)

Granular Sub-base with Graded Material B. By Mix in Place Method :Construction of granular sub-base by providing graded material, mixing by mix in place method with Rotavator at OMC, spreading in uniform layers with Motor grader on prepared surface in proper grade and camber, compacting with vibratory roller to achieve the desired density, including lighting, guarding, barricading, including cost of all materials, machinery, tools and plants including cost of quality control complete as per Clause 401 of Specifications for Area same as markedm- (A) SL NO-1 = 2867.55 m2

1	x	1	x	2867.55	x	0.30	=	860.27	m3
---	---	---	---	---------	---	------	---	--------	----

@ Rs. 1152.67 / sq.m Rs. 991602.00

2.1 P-243 It.-4.08/ B(R&B)

Granular Sub-base with Graded Material B. By Mix in Place Method :Construction of granular sub-base by providing graded material, mixing by mix in place method with Rotavator at OMC, spreading in uniform layers with Motor grader on prepared surface in proper grade and camber, compacting with vibratory roller to achieve the desired density, including lighting, guarding, barricading, including cost of all materials, machinery, tools and plants including cost of quality control complete as per Clause 401 of Specifications for Area same as markedm- (A) SL NO-1 = 2867.55 m2

1	x	1	x	1540.00	x	0.30	=	462.00	m3
---	---	---	---	---------	---	------	---	--------	----

@ Rs. 1234.75 / sq.m Rs. 570455.00

3 P-259 It.-6.01(R&B)

Dry Lean Cement Concrete Sub- base Construction of dry lean cement concrete Sub- base over a prepared sub-grade with coarse and fine aggregate conforming to IS: 383, the size of coarse aggregate not exceeding 25 mm, aggregate cement ratio not to exceed 15:1, aggregate gradation after blending to be as per table 600-1, cement content not to be less than 150 kg/ cum, optimum moisture content to be determined during trial length construction, concrete strength not to be less than 10 Mpa at 7 days, mixed in a batching plant, transported to site, laid with a paver with electronic sensor, compacting with 8-10 tonnes vibratory roller finishing and curing (As per clause 601 of specifications for Road & Bridge Works of Area same as markedm- (A) SL NO-1 = 2867.55 m2

1	x	1	x	2867.55	x	0.15	=	430.13	m3
								(B)	430.13 m3

@ Rs. 2609.01 / sq.m Rs. 4122220.00

(P-14)

286

4 P-280 lt.-12.05 (R&B)

Plain / Reinforced Cement Concrete in Open foundation with or without reinforcements, in any part of foundation of bridges / culverts with graded stone chips of appropriate nominal sizes, including screening and cleaning of coarse aggregates, fine aggregate (sand) conforming to proper grading zone, both of approved quality and cement, as necessary, cost of curing with water, including cost and carriage of all materials and including preparation of design mix, approval of the same by the Engineer-in-Charge, cost for quality control, samolina. testing etc. including cost of formwork but excluding reinforcement complete as per

Area same as markedm- (B) SL NO-3 = 2867.55 m2
1 x 2867.55 x 0.30 = 860.27 m3
860.27 m3

@ Rs. 5396.87 / cu.m
5424.05 / cu.m
5759.50

Rs.

(49,54,725.00) w
~~46,42,765.00~~
4666120.00

5 P-47 lt.-3

Supplying and laying Polythene Sheet (150gm / sq.m.) over damp proof course or below flooring or roof terracing or in foundation or in foundation trenches.

Area same as markedm- (A) SL NO-1 = 2867.55 m2

@ Rs. 24.00 / m2

Rs.

68821.00

Rs. 8377794.00

Rs. 1005335.00

Rs. 9383129.00

Rs. 93831.00

Rs. 9476960.00

Rs. 281494.00

(Rs. 97,58,454.00) w

TOTAL (A)

7603965.00

Add 12% GST on "A", (B)=

912476.00

Cost of civil work excluding cess (C), SUM OF "A+B"=

8516441.00

Add 1% cess on (C), D=

85164.00

Cost of civil work including cess (E), SUM OF "C+D"=

8601605.00

Add 3% contingency on (C)=

255493.00

GRAND TOTAL=

Rs. 8857098.00

~~8065834.00~~
~~947900.00~~
~~9032734.00~~
~~90337.00~~
~~9124071.00~~
~~276012.00~~
~~9395083.00~~

(P-15)

25/09/18

Assistant Engineer PWD
Jangipur Sub-Division

25/09/18

Executive Engineer
Berhampore Division No.I, PWD

25.09.18

29/12/16

Block Medical Officer of Health
Anupnagar B. P. H. C.
Dhuliyan, Murshidabad

Chief Medical Officer of Health
Murshidabad

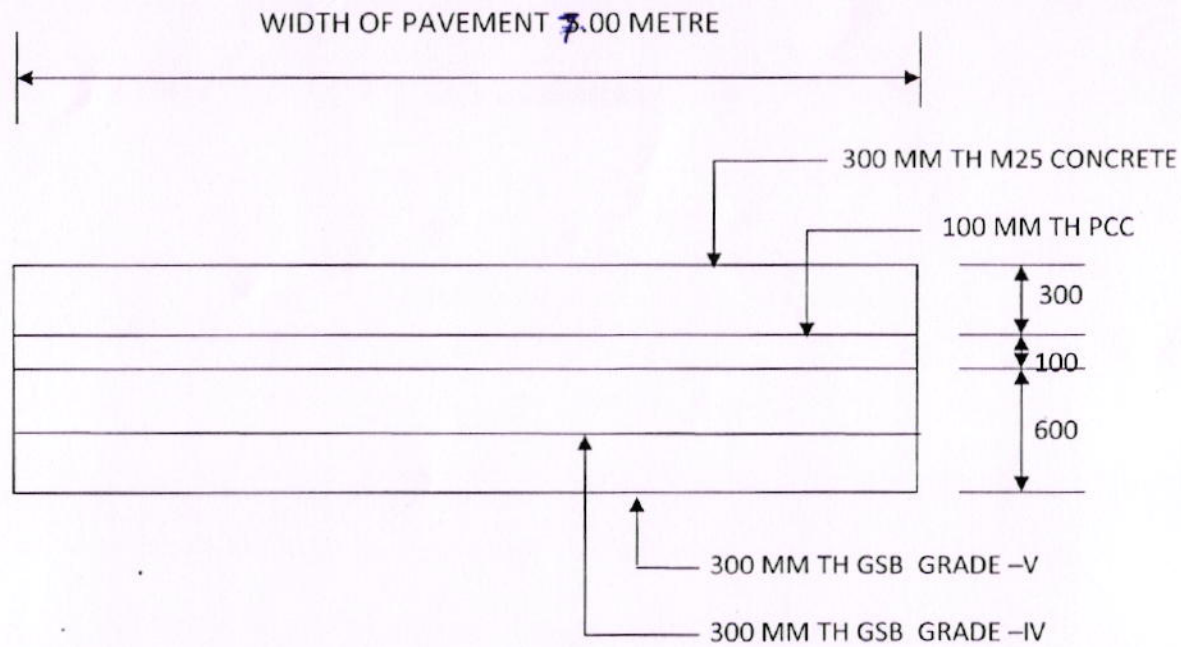

Signature
08-06-18

Signature
19/12/2018

Block Medical Officer of Health
Anupnagar B. P. H. C.
Dhuliyan, Murshidabad

Signature
08/06/18
Assistant Engineer PWD
Jangipur Sub-Division

(P-16)

Signature
25/09/18
Assistant Engineer PWD
Jangipur Sub-Division

Signature
Chief Medical Officer of Health
Murshidabad

(SL NO-16)

Construction of Drain and Plinth Protection for Proposed Construction of of G+3 Storied Mother and Child Hub at the premises of Anupnagar BPHC, Samserganj Block, Murshidabad during the year 2018-19 (Foundation to be taken G+5).

Length of Drain to be constructed = 2 x (73m + 21.0m) + 40.0 m = 228.00m

1 P-1/item-2

Earth work in excavation of foundation trenches or drains, in all sorts of soil (including mixed soil but excluding laterite or sandstone) including removing, spreading or stacking the spoils within a lead of 75 m. as directed. The item includes necessary trimming the sides of trenches, levelling, dressing and ramming the bottom, bailing out water as required complete.

a) depth of excavation not exceeding 1500mm

Drain	1 x	228.00	x	1.00	x	0.90	=	205.20	m ³	
	@	Rs.	11927.00	/	%cum					= Rs. 24474.00

2 P-2/item-4(B)

Filling in foundation or plinth by silver sand in layers not exceeding 150 mm as directed and consolidating the same by thorough saturation with water, ramming complete including the cost of supply of sand. (payment to be made on measurement of finished quantity) b) do by fine sand

Drain	1 x	228.00	x	1.00	x	0.15	=	34.20	m ³	
plinth protection	1 x	188.00	x	0.90	x	0.30	=	50.76	m ³	
								84.96	m ³	
	@	Rs.	71181.00	/	%cum					= Rs. 60475.00

3 P-14/item-1

Single Brick Flat Soling of picked jhama bricks including ramming and dressing bed to proper level and filling joints with local sand.

Drain	1 x	228.00	x	1.00	x	1	=	228.00	m ²	
plinth protection	1 x	188.00	x	0.90	x	1	=	169.20	m ²	
								397.200		
	@	Rs.	326.00	/	sq.m					= Rs. 129487.00

4 P-47/item-3

Supplying and laying Polythene Sheet (150gm / sq.m.) over damp proof course or below flooring or roof terracing or in foundation or in foundation trenches.

Drain	1 x	228.00	x	1.00	x	1	=	228.00	m ²	
plinth protection	1 x	188.00	x	0.90	x	1	=	169.20	m ²	
								397.20		
	@	Rs.	24.00	/	sq.m					= Rs. 9533.00

5 P-34/item-22

(I) Cement concrete with graded stone ballast (40 mm size excluding shuttering) In ground floor

(a) 1:3:6 proportion

Drain	1 x	228.00	x	1.00	x	0.15	=	34.20	m ³	
plinth protection	1 x	188.00	x	0.90	x	0.15	=	25.38	m ³	
								Qty. =	59.580	m ³
	@	Rs.	5188.93	/	cum					= Rs. 309156.00

6 P-42/item-36

Hire and labour charges for shuttering with centering and necessary staging upto 4 m using approved stout props and thick hard wood planks of approved thickness with required bracing for concrete slabs, beams and columns, lintels curved or straight including fitting, fixing and striking out after completion of works (upto roof of ground floor)

(f) 25 mm to 30 mm shuttering without staging in foundation

for drain Bottom	1 x	228.00	x	2	x	0.15	=	68.40	m ²	
plinth protection	1 x	188.00	x	2	x	0.15	=	28.00 56.40	m ²	
								Qty. =	124.80	m ²
									96.00	
	@	Rs.	205.00	/	sq.m					= Rs. 19803.00 ✓ 25584.00

(P-17)

4928.00
 - 345.90
 + 345.88
 4927.98

7 P-15/item-08

Brick work with 1st class bricks in cement mortar (1:6) (a) In foundation and plinth

For drain side of Plinth protection	2	x	188.00	x	0.25	x	0.45	=	42.30	m ³
For drain only	2	x	40.00	x	0.25	x	0.65	=	13.00	m ³
								Qty. =	55.30	m ³

@ Rs. 4927.98 / cum = Rs. 272,517.00

8 P-189/item-1

Plaster (to wall, floor, ceiling etc.) with sand and cement mortar including rounding off or chamfering corners as directed and raking out joints including throating, nosing and drip course, scaffolding/staging where necessary (Ground floor). [Excluding cost of chipping over concrete surface]

(i) With 1:4 cement mortar (c) 10 mm thick plaster

for drain wall inside	1	x	188.00	x	2	x	0.45	=	169.20	m ²
for drain wall outside	1	x	188.00	x	1	x	0.30	=	56.40	m ²
for drain wall top	1	x	188.00	x	1	x	0.25	=	47.00	m ²
for plinth protection top	1	x	188.00	x	1	x	0.90	=	169.20	m ²
for drain wall inside	1	x	40.00	x	2	x	0.65	=	52.00	m ²
for drain wall outside	1	x	40.00	x	2	x	0.30	=	24.00	m ²
for drain wall top	1	x	40.00	x	2	x	0.25	=	20.00	m ²
									537.80	m ²

@ Rs. 127.00 / m² = Rs. 68301.00

8 P-192/item-15

Neat cement punning about 1.5mm thick in wall, dado, window sill, floor etc. NOTE: Cement 0.152 cu.m per 100 sq.m.

Area same as sl-8

537.80 m²

@ Rs. 34.00 / m² = Rs. 18285.00

9 P-48/item-6

Artificial stone in floor, dado, staircase etc with cement concrete (1:2:4) with stone chips, laid in panels as directed with topping made with ordinary or white cement (as necessary) and marble dust in proportion (1:2) including smooth finishing and rounding off corners including raking out joints or roughening of concrete surface and application of cement slurry before flooring works using cement @ 1.75 kg/sq.m all complete including all materials and labour.

In ground floor. 3 mm. thick topping (High polishing grinding on this item is not permitted with ordinary cement). Using grey cement (ii) 25 mm. thick

In ground floor

for drain bottom	1	x	40.00	x	1	x	0.45	=	18.00	m ²
for drain bottom	1	x	188.00	x	1	x	0.35	=	65.80	m ²
									83.80	m ²

@ Rs. 264.00 / m² = Rs. 22123.00

TOTAL (A) 939935.00 939159.00

Add 12% GST on "A", (B)= 112792.00 112098.00

f civil work excluding cess (C), SUM OF "A+B"= 1052727.00 1046252.00

Add 1% cess on (C), D= 10527.00 10463.00

of civil work including cess (E), SUM OF "C+D"= 1063254.00 1056715.00

Add 3% contingency on (C)= 31582.00 31388.00

GRAND TOTAL= 1094836.00 1088103.00

Sumalika
25-09-18

(P-18)

25/09/18
Assistant Engineer PWD
Jangipur Sub-Division

11/10/18
Executive Engineer
Berhampore Division No. I, PWD

Chowdhury
19/12/2018

Block Medical Officer of Health
Anupnagar B. P. H. C.
Dhuliyan, Murshidabad

Basanta Kumar
Chief Medical Officer of Health
Murshidabad 12/12/18 (28)

Drain

Plaster + Neat Cement

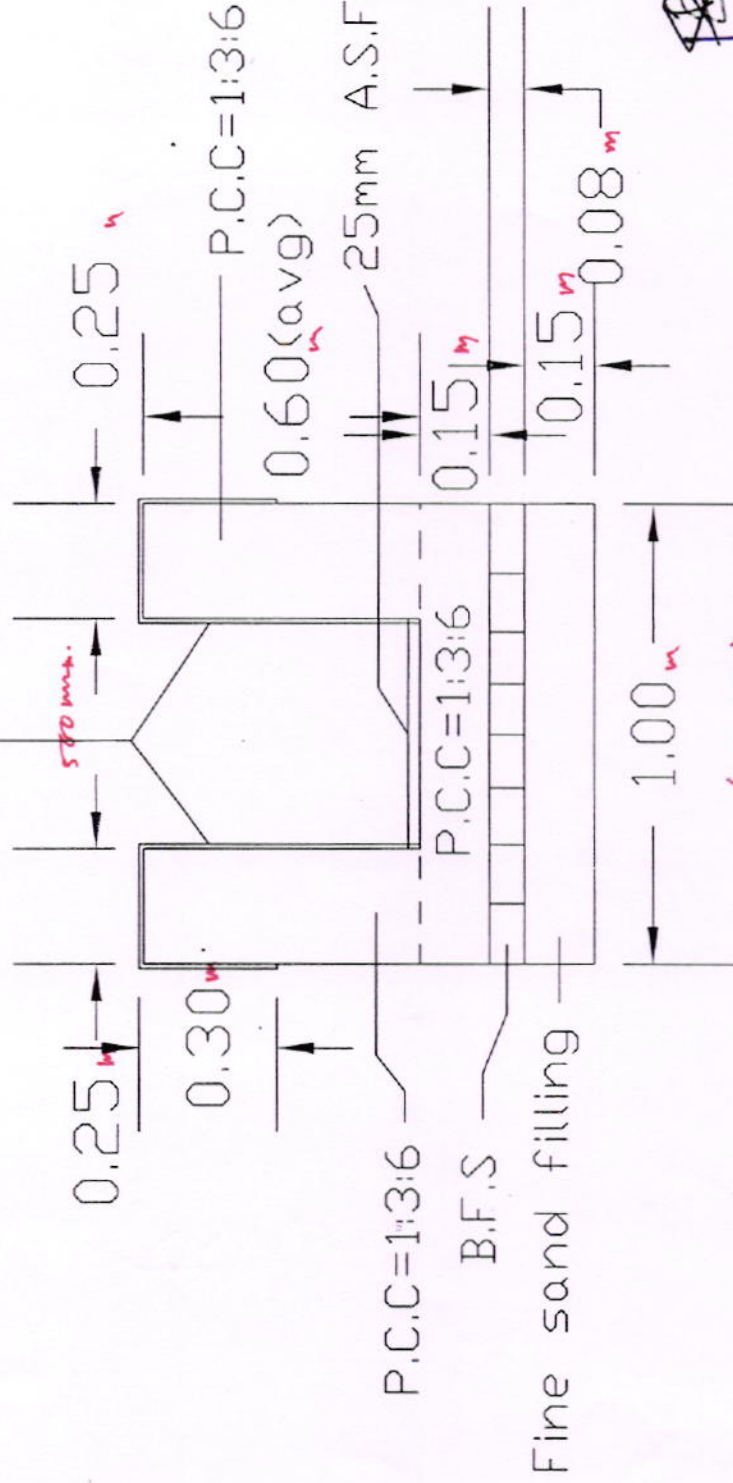

8.1.90-80

(F-19)

28/09/18

Assistant Engineer PWD
 Jangipur Sub-Division

28/06/18

 Assistant Engineer PWD
 Jangipur Sub-Division

Chief Medical Officer of Health
 Murshidabad

(SL NO - 17)

Name of work - Estimate for Construction of Under Ground R.C.C Clear Water Reservoir(CWR) of 100000 Lt. Capacity for Proposed Construction of of G+3 Storied Mother and Child Hub at the premises of Anupnagar BPHC, Samserganj Block, Murshidabad during the year 2018-19(Foundation to be taken G+5)

1 P-1/item-2

Earth work in excavation of foundation trenches or drains, in all sorts of soil (including mixed soil but excluding laterite or sandstone) including removing, spreading or stacking the spoils within a lead of 75 m. as directed. The item includes necessary trimming the sides of trenches, levelling, dressing and ramming the bottom, bailing out water as required complete.

a) depth of excavation not exceeding 1500mm

1 X 9.50 x 8.50 x 1.50 = 121.13 m³
Qty. = 121.13 m³

@ Rs. 11927.00 / %cum = Rs. 14447.00

b) depth of excavation beyond 1500mm

1 X 9.50 x 8.50 x 0.500 = 40.38 m³

1 X 0.60 x 0.60 x 0.500 = 0.18 m³

Qty. = 40.56 m³

@ Rs. 19238.00 / %cum = Rs. 7803.00

2 P-2/item-4(B)

Filling in foundation or plinth by silver sand in layers not exceeding 150 mm as directed and consolidating the same by thorough saturation with water, ramming complete including the cost of supply of sand. (payment to be made on measurement of finished quantity)

b) do by fine sand

1 X 9.50 x 8.50 x 0.30 = 24.23 m³

Qty. = 24.23 m³

@ Rs. 71181.00 / %cum = Rs. 17244.00

3 P-14/item-1

Single Brick Flat Soling of picked jhama bricks including ramming and dressing bed to proper level and filling joints with local sand.

1 X 9.50 x 8.50 = 80.75 m²

Qty. = 80.75 m²

@ Rs. 326.00 / sq.m = Rs. 26325.00

4 P-34/item-22

l) Cement concrete with graded stone ballast (40 mm size excluding shuttering) In ground floor

(A) [Pakur Variety] (a) 1:3:6 proportion

1 X 9.50 x 8.50 x 0.10 = 8.075 m³

Qty. = 8.075 m³

@ Rs. 5188.93 / cum = Rs. 41901.00

5 P-25/item-6

Controlled Cement concrete with well graded stone chips (20 mm nominal size) excluding shuttering and reinforcement with complete design of concrete as per IS : 456 and relevant special publications, submission of job mix formula after preliminary mix design after testing of concrete cubes as per direction of Engineer- in charge.

Consumption of cement will not be less than 300 Kg of cement with Super plasticiser per cubic meter of controlled concrete but actual consumption will be determined on the basis of preliminary test and job mix formula. In ground floor and foundation.[using concrete mixture](b) M 25 Grade (i) Pakur Variety

For base 1 X 9.20 x 8.20 x 0.35 = 26.40 m³

For wall 2 X 8.50 x 0.30 x 2.20 = 10.941.35 m³

2 X 7.50 x 0.30 x 2.20 = 9.6910.03 m³

bottom hontz 2 X 8.60 x 0.30 x 0.30 x 1/2 = 0.72 m³

bottom hontz 2 X 7.60 x 0.30 x 0.30 x 1/2 = 0.68 m³

sump 2 X 0.60 x 0.30 x 0.50 = 0.18 m³

top slab 1 X 9.20 x 8.20 x 0.150 = 11.32 m³

60.742 m³

@ Rs. 5976.27 / cum = Rs. 363011.00

(P-20)

6 P-27/item-15

Reinforcement for Reinforced concrete work in all sorts of structure in/c distribution bars, stirrups, binders etc in/c supply of rods initial straightening and removal of loose rust (if necessary) cutting to requisite length, hooking and bending to correct shape, placing in proper position and binding with 16 gauge black annealed wire at every intersection comp as per drawing and direction.

a) for works in foundation, basement and upto roof of g/floor / upto 4m.

i) tor steel/mild steel

SAIL/TATA/RINL

in ground floor: (@2.0% of concrete volume)

$$59.85 \times 60.74 \times 0.020 \times 7.85 = 9.396 \text{ MT}$$

$$9.396 \text{ MT} = 9.536 \text{ MT}$$

Say Qty. = 9.536 MT

$$@ \text{ Rs. } 70215.85 / \text{ MT} = \text{ Rs. } 669613.00$$

(667290.00) ✓
669613.00 ✓

7 P-42/item-36

Hire and labour charges for shuttering with centering and necessary staging upto 4 m using approved stout props and thick hard wood planks of approved thickness with required bracing for concrete slabs, beams and columns, lintels curved or straight including fitting, fixing and striking out after completion of works (upto roof of ground floor)

(c) Steel shuttering or 9 to 12 mm thick approved quality ply board shuttering in any concrete work

base	2	x	9.20	x	0.35	=	6.44	m ²
base	2	x	8.20	x	0.35	=	5.74	m ²
WALL OUTSIDE	2	x	8.60	x	2.20	=	37.84	m ²
	2	x	7.60	x	2.20	=	33.44	m ²
wall inside	2	x	8.00	x	2.20	=	35.20	m ²
	2	x	7.00	x	2.20	=	30.80	m ²
slab	1	x	8.20	x	9.20	=	75.44	m ²
slab side	2	x	8.20	x	0.15	=	2.46	m ²
slab side	2	x	9.20	x	0.15	=	2.76	m ²
sump	2	x	0.60	x	0.50	=	0.60	m ²
							230.72	m ²
						Qty. =	230.72	m ²

@ Rs. 365.00 / sq.m = Rs. 84213.00

(f) 25 mm to 30 mm shuttering without staging in foundation

Gr. floor For P.C.C	1	X	9.50	x	2	x	0.10	=	1.90	m ²
Gr. floor For P.C.C	1	X	8.50	x	2	x	0.10	=	1.70	m ²
								=	3.60	m ²

@ Rs. 205.00 / sq.m = Rs. 738.00

8 P-47/item-3

Supplying and laying Polythene Sheet (150gm / sq.m.) over damp proof course or below flooring or roof terracing or in foundation or in foundation trenches.

Qty same as Sl no - 3 = 80.75 m²

@ Rs. 24.00 / sq.m = Rs. 1938.00

9 P-45/item-8a

(a) Applying 2 coats of bonding agent with synthetic multi functional rubber emulsion having adhesive and water proofing properties by mixing with water in proportion (1 bonding agent : 4 water : 6 cement) as per Manufacturer's specification

WALL inside	2	x	8.00	x	2.20	=	35.20	m ²
WALL inside	2	x	7.00	x	2.20	=	30.80	m ²

(P-24)

floor	1 x	8.00 x	7.00	=	56.00 m ²
WALL outside	2 x	8.60 x	2.20	=	37.84 m ²
WALL outside	2 x	7.60 x	2.20	=	33.44 m ²
sump wall	2 x	0.60 x	0.50	=	0.60 m ²
				Qty. =	193.88 m ²

@ Rs. 88.00 / m² = = Rs. 17061.00

10 P-189/item-1

Plaster (to wall, floor, ceiling etc.) with sand and cement mortar including rounding off or chamfering corners as directed and raking out joints including throating, nosing and drip course, scaffolding/staging where necessary (Ground floor).[Excluding cost of chipping over concrete surface]

(ii) With 1:4 cement mortar

(c) 10 mm thick plaster

WALL inside	2 x	8.00 x	2.20	=	35.20 m ²
WALL inside	2 x	7.00 x	2.20	=	30.80 m ²
sump WALL	2 x	0.60 x	0.50	=	0.60 m ²
top	1 x	9.20 x	8.20	=	75.44 m ²
WALL outside	2 x	8.60 x	2.20	=	37.84 m ²
WALL outside	2 x	7.60 x	2.20	=	33.44 m ²
				Qty. =	213.32 m ²

@ Rs. 127.00 / m² = = Rs. 27092.00

11 P-192/item-15

Neat cement punning about 1.5mm thick in wall,dado,window sill,floor etc.

WALL inside	2 x	8.00 x	2.20	=	35.20 m ²
WALL inside	2 x	7.00 x	2.20	=	30.80 m ²
sump wall	2 x	0.60 x	0.50	=	0.60 m ²
WALL outside	2 x	8.60 x	2.20	=	37.84 m ²
WALL outside	2 x	7.60 x	2.20	=	33.44 m ²
				Qty. =	137.88 m ²

@ Rs. 34.00 / m² = = Rs. 4688.00

12 P-48/item-6)

Artificial stone in floor, dado, staircase etc with cement concrete (1:2:4) with stone chips, laid in panels as directed with topping made with ordinary or white cement (as necessary) and marble dust in proportion (1:2) including smooth finishing and rounding off corners including raking out joints or roughening of concrete surface and application of cement slurry before flooring works using cement @ 1.75 kg/sq.m all complete including all materials and labour.

3 mm. thick topping (High polishing grinding on this item is not permitted with ordinary cement).

Using grey cement iii) 35mm thick

floor	1 x	8.00 x	7.00	=	56.00 m ²
				Qty. =	56.00 m ²

@ Rs. 322.00 / m² = = Rs. 18032.00

13 P-192/item-1

Labour for Chipping of concrete surface before taking up Plastering work.

Qty same as sl no-9 of 10 mm thick (1:4) plastering area

Qty. = 213.32 m²

@ Rs. 21.00 / m² = = Rs. 4480.00

(P-22)

14 P-2/item-1(S&P|)

Supplying, fitting and fixing G.I. pipes of TATA make with all necessary accessories, specials viz. socket, bend, tee, union, cross, elbo, nipple, longscrew, reducing socket, reducing tee, short pieces etc. fitted with holder bats clamps, including cutting pipes, making threads, fitting, fixing etc. complete in all respect including cost of.....any position above ground. (payment will be made....separately)

(A) For exposed work (f) (ii) 50mm dia

hostel	2 x	4	x	3.3	=	26.4
hostel	2 x	1	x	1.5	=	3.0
hostel	2 x	1	x	0.9	=	1.8
					Qty. =	31.20 m

@ Rs. 540.00 / m = Rs. 16848.00

15 P-3/item-2(S&P|)

Supplying, fitting and fixing in position G.I.pipes of TATA make for underground works with all necessary accessories, specials viz. socket, bend, tee, union, cross, elbow, nipple, short piece etc. including cost of all materials, jointing materials, cutting pipes, making threads, cutting trenches upto 1.5 metre below surface in all sorts of soil and refilling the same as directed with two coats of painting on G.I. pipes and specials with bituminous paint complete in all respect. (Payment will be made on the centre line measurement of the total pipe line including all specials No separate payment will be mad

For underground work (vi) 50mmdia

hostel	2 x	1	x	50	=	100.0
					Qty. =	100.00 m

@ Rs. 520.00 / m = Rs. 52000.00

16 P-5/item-5(iv)(S&P|)

Supplying, fitting and fixing gunmetal wheel valve of approved brand and make tested to 21 kg per sq. cm. (for water lines only)

(iv) 50 mm dia	2 x	3	=	6 no
			Qty. =	6 no

@ Rs. 2277.00 / each = Rs. 13662.00

17 P-37/item-7(S&P|)

Supplying, fitting and fixing cast iron raised rain proof tank cover 450mm

	1 x	3	=	3 no
			Qty. =	3 no

@ Rs. 1014.00 / each = Rs. 3042.00

Total = Rs. 1384137.00 *1376487.00*

Add 12% GST on "A", (B)= 166096.00 *165178.00*

Cost of civil work excluding cess (C), SUM OF "A+B"= 1550233.00 *1541665.00*

Add 1% cess on (C), D= 15502.00 *1541700*

Cost of civil work including cess (E), SUM OF "C+D"= 1565735.00 *1557082.00*

Add 3% contingency on (C)= 46507.00 *46250.00*

GRAND TOTAL= 1612242.00 *Rs. (1603332.00)*

(P-23)

J. Maestri
25.09.18

Junior Engineer, Sec-III PWD, Jangipur Sub-Division

25/09/18
Assistant Engineer PWD Jangipur Sub-Division

Assistant Engineer PWD
Jangipur Sub-Division

[Signature]
Executive Engineer
Berhampore Division No.I, PWD

[Signature]
19/12/2018
Block Medical Officer of Health
Anupnagar B. P. H. C.
Dhuliyani, Murshidabad

[Signature]
Chief Medical Officer of Health
Murshidabad
18/12/18

UNDER GROUND R.C.C CLEAR WATER RESERVIOR 100,000 LITER CAPACITY

Top slab projection:

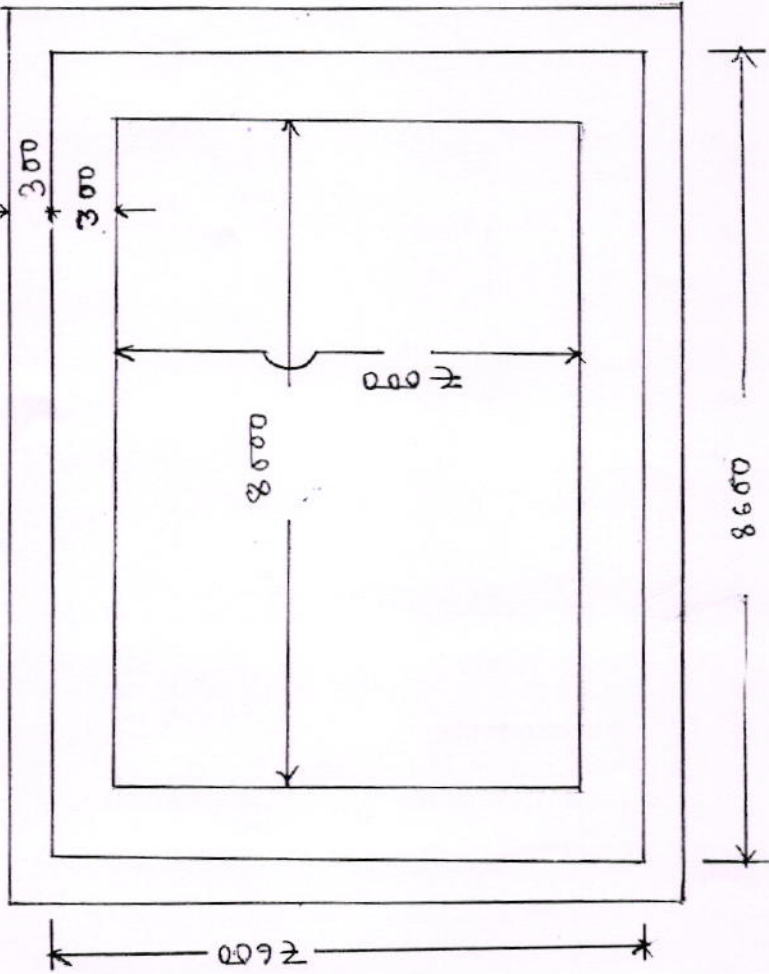

PLAN

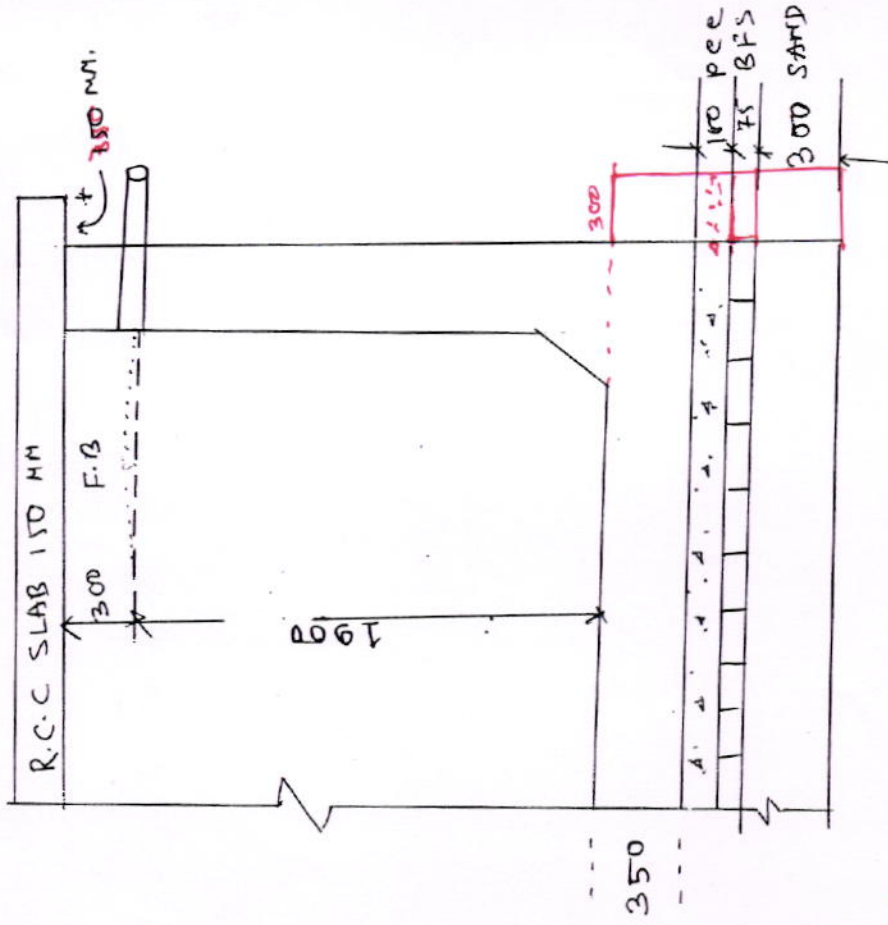

CROSS SECTION

(P-24)

[Signature]
28/09/18

[Signature]
29/12/2018
Block Medical Officer of Health
Anupnagar B. P. H. C.
Dhuliyan, Murshidabad

[Signature]
28/09/18
Assistant Engineer PWD
Jangipur Sub-Division

[Signature]
28/09/18
Assistant Engineer PWD
Jangipur Sub-Division

[Signature]
Responsible
Chief Medical Officer of Health
Murshidabad

(SL NO - 18)

Horticulture work within the perimeter Proposed Construction Proposed Construction of G+3 Storied Mother and Child Hub at the premises of Anupnagar BPHC, Samserganj Block, Murshidabad during the year 2018-19 (Foundation to be taken G+5)

1	P-259/item-1 Supplying and stacking of good earth (adequate for horticulture work) at site including royalty (earth easured in stack will be reduced by 20% for payment)	45.00 x 20.00 x 0.075 = 67.50 m3 40.00 x 30.00 x 0.075 = 90.00 m3 Qty. 157.50 m	@ Rs 306.00 /cum	= Rs 48195.00
2	P-259/item-2 Supplying and stacking sludge (adequate for Horticulture work) at site in dry cake form from approved disposal work site including royalty, all lead and lift etc. (Sludge measured in stack will be reduced by 8%).	45.00 x 20.00 x 0.075 = 67.50 m3 40.00 x 30.00 x 0.075 = 90.00 m3 Qty. 157.50 m3	@ Rs 457.00 /cum	= Rs 71978.00
3	P-259/item-3 Spreading of sludge dump manure,/farm yard manure/animal dung manure and good earth inrequired thickness. This includes supply of labour, tools & plants excluding materials	45.00 x 20.00 = 900.00 m2 40.00 x 30.00 = 1200.00 m2 Qty. 2100.00 m2	@ Rs 175.00 %sqm	= Rs 3675.00
4	P-259/item-4 Supplying and fixing grasses tiles of grass Maxican Carpet/Selection No. 1 Healthy & fresh grasses (size 1'x1' or bigger) including watering and maintenance of the lawn for 30 days or more till the grass forms a thick lawn free from weeds and fit for mowing including supplying good earth as required by Engineer-in-charge. (Rate includes supply of labour, tools & plants including materials)	45.00 x 15.00 = 675.00 m2 40.00 x 25.00 = 1000.00 m2 Qty. 1675.00 m2	@ Rs 20142.00 %sqm	= Rs 337379.00
5	P-260/item-5 Preparation of beds for hedging and shrubbery by excavating 60cm deep and trenching the excavated base to a further depth of 30cm, refilling the excavated earth after breaking clods and mixing with sludge or manure in the ratio of 8:1 (8 parts of stacked volume of earth after reduction by 20%, one part of stacked volume of sludge or manure after reduction by 8%), flooding with water, filling with earth if necessary watering and finally fine dressing, levelling etc. including stacking and disposal of materials declared unserviceable and surplus earth by spreading and levelling as directed, within a lead of 50m lift upto 1.5m complete. This includes supply of labour, tools & plants including materials. Planting hedge plants in two rows at 30cm apart	45.00 x 5.00 = 225.00 m2 40.00 x 5.00 = 200.00 m2 Qty. 425.00 m2	@ Rs 3530.00 %sqm	= Rs 15003.00
6	P-260/item-6 Maintenance of hedge for one year including application of necessary pesticide, farm yard manure, replacement of damaged hedge plant by new one complete in all respect as per instruction of Engineer-in-charge. This includes supply of labour, tools & plants including materials.	300.00 x 0.45 = 135.00 m2 Qty. 135.00 m2	@ Rs 11770.00 %sqm	= Rs 15890.00
7	P-260/item-7 Planting of trees (Avenue plants) in 0.60m dia holea. 1m deep dug in the ground. mixing the soil with decayed farm yard/sludge manure. This includes supply of labour, tools & plants including materials but excluding cost of tree i) Furcaria veriegated 10-12 leaves in height 20-30cm in earthen pots of size 25cm			

(P-25)

xxxvii) Eranthemum Species of height 30 cm to 90 cm in earthen pots of size 20 cm.	1 x 12	=	12	no
xxvi) Areca Palm 4 - 5 suckers of height 90 cm to 105 cm in earthen pots of size 25 cm	1 x 40	=	40	no
xxxviii) Hibiscus Rosa sinensis of height 90 cm to 60 cm in earthen pots of size 20 cm	1 x 20	=	20	no
	1 x 100	=	100	no
		Qty.	172	no

@ Rs 117.00 each = Rs 20124.00

8 P-260/item-8

Maintanance of trees for one year (Avenue Plants) including watering, trimming, manuring, spraying insecticide and guarding as required. This includes supply of labour, tools & plants including materials

i) Furcaria veriegated 10-12 leaves in height 20-30cm in earthen pots of size 25cm

xxxvii) Eranthemum Species of height 30 cm to 90 cm in earthen pots of size 20 cm.	1 x 12	=	12	no
xxvi) Areca Palm 4 - 5 suckers of height 90 cm to 105 cm in earthen pots of size 25 cm	1 x 40	=	40	no
xxxviii) Hibiscus Rosa sinensis of height 90 cm to 60 cm in earthen pots of size 20 cm	1 x 20	=	20	no
	1 x 100	=	100	no
		Qty.	172	no

@ Rs 477.00 each per year = Rs 82044.00

9 P-261/item-9

Supplying and Planting of different plant / trees (Supplying well grown plants bushy and healthy, minimum height as specified i.e. exposed height including all leads & lift, carriage, handling, manuring, applying presticide and fertilizer etc.

i) Furcaria veriegated 10-12 leaves in height 20-30cm in earthen pots of size 25cm

	1 x 12	=	12	no
		Qty.	12	no

@ Rs 162.00 each = Rs 1944.00

ii) Rangon chineese of size not less than 20cm

	1 x 600	=	600	no
		Qty.	600	no

@ Rs 12.00 each = Rs 7200.00

xxxvii) Eranthemum Species of height 30 cm to 90 cm in earthen pots of size 20 cm.

	1 x 40	=	40	no
		Qty.	40	no

@ Rs 51.00 each = Rs 2040.00

xxvi) Areca Palm 4 - 5 suckers of height 90 cm to 105 cm in earthen pots of size 25 cm

	1 x 20	=	20	no
		Qty.	20	no

@ Rs 127.00 each = Rs 2540.00

xxxviii) Hibiscus Rosa sinensis of height 90 cm to 60 cm in earthen pots of size 20 cm

	1 x 100	=	100	no
		Qty.	100	no

@ Rs 42.00 each = Rs 4200.00

TOTAL (A) 612212.00

Add 12% GST on "A", (B)= 73465.00

st of civil work excluding ccess (C),SUM OF "A+B"= 685677.00

Add 1% ccess on (C), D= 6857.00

ost of civil work including ccess (E),SUM OF "C+D"= 692534.00

Add 3% contigency on (C)= 20570.00

GRAND TOTAL= 713104.00

(P-26)

[Signature]
25-09-18
Junior Engineer, Sec-III PWD,
Jangipur Sub-Division

[Signature] 25/09/18
Assistant Engineer PWD Jangipur
Sub-Division

[Signature]
4/10/18
Executive Engineer
Berhampore Division No.I, PWD

[Signature]
19/12/2018
Block Medical Officer of Health
Anupnagar B. P. H. C.
Dhuliyani, Murshidabad

[Signature]
36
Chief Medical Officer of Health
Murshidabad 19/12/18

(SL NO - 19)

Name of work- Construction of Substation Building for Proposed Mother and Child Hub at the premises of Anupnagar BPHC, Samserganj Block, Murshidabad during the year 2018-19

1 P-1/item-2									
Earth work in excavation of foundation trenches or drains, in all sorts of soil (including mixed soil but excluding laterite or sandstone) including removing, spreading or stacking the spoils within a lead of 75 m. as directed. The item includes necessary trimming the sides of trenches, levelling, dressing and ramming the bottom, bailing out water as required complete.									
a) depth of excavation not exceeding 1500mm									
for foudation	31.00	x	1.80	x	1.50	=	83.70	m ³	
	31.00	x	2.20	x	1.50	=	102.30	m ³	
road	35.00	x	3.00	x	0.35	=	36.75	m ³	
						Qty.	=	222.75	m ³
	@	Rs. 11927.00	/	%cum			=	Rs.	26,567.00
b) depth of excavation for addl depth beyond 1500 mm and upto 3000 mm									
for foudation	31.00	x	1.80	x	1.00	=	55.80	m ³	
	31.00	x	2.20	x	1.00	=	68.20	m ³	
						Qty.	=	124.00	m ³
	@	Rs. 19238.00	/	%cum			=	Rs.	23,855.00
2 P-1/item-3									
Earthwork in filling in foundation trenches or plinth with good earth in layers not exceeding 150mm in/c watering and ramming etc layer by layer complete(a) With earth obtained from excavation of foundation.									
	(222.75	+	124.00)	1/2	=	69.35	m ³
						Qty.	=	69.35	m ³
	@	Rs. 7754.00	/	%cum			=	Rs.	5,377.00
3 P-2/item-4(B)									
Filling in foundation or plinth by silver sand in layers not exceeding 150 mm as directed and consolidating the same by thorough saturation with water, ramming complete including the cost of supply of sand. (payment to be made on measurement of finished quantity)									
b) do by fine sand									
Below strip foundation	1	x	31.00	x	1.80	x	1.00	=	55.80 m ³
	1	x	31.00	x	2.20	x	1.00	=	68.20 m ³
P.L	1	x	30.00	x	6.20	x	0.75	=	139.50 m ³
road			35.00	x	3.00	x	0.25	=	26.25 m ³
						Qty.	=	289.75	m ³
	@	Rs. 71181.00	/	%cum			=	Rs.	206,247.00
4 P-14/item-1									
Single Brick Flat Soling of picked jhama bricks including ramming and dressing bed to proper level and filling joints with local sand.									
For plinth protection	1		x	30.15	x	0.60	=	18.09	m ²
	2		x	6.95	x	0.60	=	8.34	m ²
						Qty.	=	26.43	m ²
	@	Rs. 326.00	/	sq.m			=	Rs.	8,616.00
5 P-47/item-3									
Supplying and laying Polythene Sheet (150gm / sq.m.) over damp proof course or below flooring or roof terracing or in foundation or in foundation trenches.									
Below strip foundation	1	x	31.00	x	1.80	x	1	=	55.80 m ²
	1	x	31.00	x	1.80	x	1	=	55.80 m ²
P.L	1	x	30.00	x	6.20	x	1	=	186.00 m ²
road			35.00	x	3.00	x	1	=	105.00 m ²
for tie beam	7	x	5.50	x	0.25	x	1	=	9.63 m ²
								412.23	m ²
	@	Rs.	24.00	/	sq.m		=	Rs.	9,892.00
6 P-34/item-22(A)									
(I) Cement concrete with graded stone ballast (40 mm size excluding shuttering) In ground floor									
(A) [Pakur Variety](a) 1:3:6 proportion									
Below strip foundation	1	x	31.00	x	1.80	x	0.075	=	4.19 m ³
	1	x	31.00	x	2.20	x	0.075	=	5.12 m ³
P.L	1	x	30.00	x	6.20	x	0.075	=	13.95 m ³
road			35.00	x	3.00	x	0.075	=	7.875 m ³
for tie beam	7	x	5.50	x	0.25	x	0.10	=	0.96 m ³
For plinth protection	1	x	30.50	x	0.75	x	0.10	=	2.29 m ³

(P-27)

(39.385 m³)

	2	x	6.95	x	0.75	x	0.10	=	1.04	m ³
wbsedcl HT	2	x	2.00	x	1.03	x	0.10	=	0.41	m ³
wbsedcl HT	1	x	4.00	x	1.03	x	0.10	=	0.41	m ³
PWDI HT	1	x	5.00	x	0.875	x	0.10	=	0.44	m ³
PWDI HT	2	x	2.00	x	0.875	x	0.10	=	0.35	m ³
Transformer 2	2	x	2.00	x	0.875	x	0.10	=	0.35	m ³
Transformer 2	1	x	5.00	x	0.875	x	0.10	=	0.44	m ³
Transformer 1	2	x	2.00	x	0.875	x	0.10	=	0.35	m ³
Transformer 1	1	x	5.00	x	0.875	x	0.10	=	0.44	m ³
, LT paneletc	2	x	4.10	x	0.875	x	0.10	=	0.72	m ³
, LT paneletc	1	x	7.00	x	0.875	x	0.10	=	0.61	m ³

Qty. = ~~32.06~~ m³
39.945

@ Rs. 5188.93 / cum = Rs.

(207272.00) ✓
166,331.00

7 P-25/item-6

Controlled Cement concrete with well graded stone chips (20 mm nominal size) excluding shuttering and reinforcement with complete design of concrete as per IS : 456 and relevant special publications, submission of job mix formula after preliminary mix design after testing of concrete cubes as per direction of Engineer- in charge. Consumption of cement will not be less than 300 Kg of cement with Super plasticiser per cubic meter of controlled concrete but actual consumption will be determined on the basis of preliminary test and job mix formula. In ground floor and foundation.
[using concrete mixture](b) M 25 Grade(i) Pakur Variety

For footing	1	x	31.00	x	1.70	x	0.25	=	13.18	m ³
	1	x	31.00	x	2.10	x	0.25	=	16.28	m ³
Foundation beam	1	x	31.00	x	0.60	x	0.30	=	5.58	m ³
	2	x	31.00	x	0.60	x	0.30	=	11.16	m ³
for column upto tiebeam	14	x	0.30	x	0.45	x	0.60	=	1.13	m ³
upto tiebeam top	7	x	0.30	x	0.35	x	0.60	=	0.44	m ³
for tie beam	5	x	5.50	x	0.25	x	0.40	=	2.75	m ³
for tie beam	2	x	6.95	x	0.25	x	0.45	=	1.56	m ³
column GL to PL	14	x	0.30	x	0.45	x	1.10	=	2.08	m ³
column GL to PL	7	x	0.30	x	0.35	x	1.10	=	0.81	m ³
column upto lintel	14	x	0.30	x	0.45	x	2.10	=	3.97	m ³
column upto lintel	7	x	0.30	x	0.35	x	2.10	=	1.54	m ³
Lintel	2	x	30.15	x	0.25	x	0.15	=	2.26	m ³
Lintel	1	x	27.50	x	0.25	x	0.15	=	1.03	m ³
Lintel	7	x	5.00	x	0.25	x	0.15	=	1.31	m ³
chajja	1	x	30.15	x	0.45	x	0.10	=	1.36	m ³
For stair toe	1	x	1.20	x	0.60	x	0.25	=	0.18	m ³
For stair waist slab	2	x	1.20	x	4.75	x	0.15	=	1.71	m ³
Tread & Riser	15	x	1.20	x	0.30	x	0.15	=	0.81	m ³
For 1st landing	1	x	2.40	x	1.45	x	0.15	=	0.52	m ³
For 1st landing beam	1	x	2.40	x	0.25	x	0.45	=	0.27	m ³
column upto roof beam	14	x	0.30	x	0.45	x	1.75	=	3.31	m ³
column GL to PL	7	x	0.30	x	0.35	x	1.75	=	1.29	m ³
roof beam	3	x	30.15	x	0.25	x	0.40	=	9.05	m ³
roof beam	7	x	6.95	x	0.25	x	0.40	=	4.87	m ³
Roof	1	x	27.50	x	6.95	x	0.125	=	23.89	m ³
Roof	1	x	2.40	x	1.20	x	0.125	=	0.36	m ³
Road	1	x	35.00	x	3.00	x	0.15	=	15.75	m ³

128.45 m³

@ Rs. 5976.97 / cum = Rs.

(767742.00) ✓
767,663.00

(P-28)

7.1 1-st Floor

column stari room	4	x	0.30	x	0.45	x	2.70	=	1.46	m ³
column for vertical ext'n	10	x	0.30	x	0.45	x	0.90	=	1.22	m ³
column for vertical ext'n	7	x	0.30	x	0.35	x	0.90	=	0.66	m ³
Lintel	1	x	1.50	x	0.25	x	0.15	=	0.06	m ³
chajja	1	x	1.50	x	0.45	x	0.10	=	0.07	m ³
									<u>3.46</u>	m ³

add extra Rs. 95.00/m³ @ Rs. 6071.97 / cum = Rs.

(21070.00) ✓
20,998.00

8 P-43/item-40

Reinforcement for Reinforced concrete work in all sorts of structure in/c distribution bars, stirrups, binders etc in/c supply of rods initial straightening and removal of loose rust (if necessary) cutting to requisite length, hooking and bending to correct shape, placing in proper position and binding with 16 gauge black annealed wire at every intersection comp as per drawing and direction.

a) for works in foundation, basement and upto roof of g/floor / upto 4m.

i) for tor steel/mild steell. SAIL/ TATA/RINL

in ground floor: (@1.5% of concrete volume)

	128.45	x	0.015	x	7.85	=	10.082	MT
					Qty.	=	10.082	MT
@ Rs.	70215.85	/	MT					

(1062045.00) ✓
707,937.00

8.1 in 1st floor:

(@1.4% of concrete volume)

	3.46	x	7.85	x	0.011	=	0.2988	MT
					Qty.	=	0.2988	MT
@ Rs.	71624.33	/	MT					

(35336.00) ✓
21,388.00

add extra Rs. 430.00/MT @ Rs.

9 P-42/item-36

Hire and labour charges for shuttering with centering and necessary staging upto 4 m using approved stout props and thick hard wood planks of approved thickness with required bracing for concrete slabs, beams and columns, lintels curved or straight including fitting, fixing and striking out after completion of works (upto roof of ground floor)

(c) Steel shuttering or 9 to 12 mm thick approved quality ply board shuttering in any concrete work

column GL to PL	14	x	2	x	0.45	x	1.10	=	13.86	m ²
column GL to PL	14	x	2	x	0.30	x	1.10	=	9.24	m ²
column GL to PL	7	x	2	x	0.35	x	1.10	=	5.39	m ²
column GL to PL	7	x	2	x	0.30	x	1.10	=	4.62	m ²
column upto lintel	14	x	2	x	0.45	x	2.10	=	26.46	m ²
column upto lintel	14	x	2	x	0.30	x	2.10	=	17.64	m ²
column upto lintel	7	x	2	x	0.35	x	2.10	=	10.29	m ²
column upto lintel	7	x	2	x	0.30	x	2.10	=	8.82	m ²
Lintel side	2	x	2	x	31.15	x	0.15	=	18.69	m ²
Lintel bottom	1	x	5	x	2.50	x	0.25	=	3.13	m ²
Lintel side	1	x	2	x	27.50	x	0.15	=	8.25	m ²
Lintel bottom	1	x	2	x	30.15	x	0.25	=	15.08	m ²
Lintel side	7	x	2	x	5.00	x	0.15	=	10.50	m ²
Lintel bottom	1	x	2	x	1.20	x	0.25	=	0.60	m ²
chajja	1	x	30.15	x	0.45	x	1	=	13.57	m ²
chajja	1	x	30.15	x	0.10	x	1	=	3.02	m ²
For stair toe	1	x	1.20	x	0.60	x	2	=	1.44	m ²
For stair toe	1	x	1.20	x	0.15	x	2	=	0.36	m ²
For stair waist slab	2	x	1.20	x	4.75	x	1	=	11.40	m ²
For stair waist slab side	2	x	0.35	x	4.75	x	2	=	6.65	m ²
Riser	15	x	1.20	x	0.15	x	2	=	5.40	m ²
For 1st landing	1	x	2.40	x	1.45	x	1.00	=	3.48	m ²
For 1st landing beam	1	x	2.40	x	0.25	x	1	=	0.60	m ²
For 1st landing beam	2	x	2.40	x	0.45	x	1	=	2.16	m ²
column upto roof beam	14	x	2	x	0.45	x	1.75	=	22.05	m ²

(P-29)

column upto roof beam	14	x	2	x	0.30	x	1.75	=	14.70	m ²
column GL to PL	7	x	2	x	0.35	x	1.75	=	8.58	m ²
column GL to PL	7	x	2	x	0.30	x	1.75	=	7.35	m ²
roof beam side	3	x	30.15	x	2	x	0.40	=	72.36	m ²
roof beam side	7	x	6.95	x	2	x	0.40	=	38.92	m ²
Roof	1	x	27.50	x	6.95	x	1	=	191.13	m ²
Roof	1	x	2.40	x	1.20	x	1	=	2.88	m ²
Roof side	1	x	30.15	x	0.125	x	2	=	7.54	m ²
Roof side	1	x	6.95	x	0.125	x	2	=	1.74	m ²
Road	1	x	35.00	x	2	x	0.15	=	10.50	m ²
Road	1	x	3.00	x	7	x	0.15	=	3.15	m ²
									<u>581.52</u>	m ² (A)
									<u>582.55</u>	
@ Rs.			365.00	/		sq.m			=	Rs. <u>(212631.00)</u>
										<u>212,254.00</u>

9.1 in 1st floor:

column stari room	4	x	2	x	0.45	x	2.70	=	9.72	m ²
column stari room	4	x	2	x	0.30	x	2.70	=	6.48	m ²
column for vertical ext ⁿ	10	x	2	x	0.45	x	0.90	=	8.10	m ²
column for vertical ext ⁿ	10	x	2	x	0.30	x	0.90	=	5.40	m ²
column for vertical ext ⁿ	7	x	2	x	0.35	x	0.90	=	4.41	m ²
column for vertical ext ⁿ	7	x	2	x	0.30	x	0.90	=	3.78	m ²
Lintel	1	x	2	x	1.50	x	0.15	=	0.45	m ²
Lintel	1	x	1	x	1.50	x	0.25	=	0.38	m ²
chajja	1	x	1.50	x	0.45	x	1	=	0.68	m ²
chajja	1	x	1.50	x	0.10	x	1	=	0.15	m ²
									<u>39.55</u>	m ² (B)
add extra Rs. 18.00/m ²	@ Rs.		363.00	/		sq.m			=	Rs. <u>(15148.00)</u>
										<u>15,144.00</u>

9.2 (f) 25 mm to 30 mm shuttering without staging in foundation

For P.C.C	2	x	31.00	x	1	x	0.075	=	2.33	m ²
	2	x	1.80	x	1	x	0.075	=	0.140	m ²
	1	x	31.00	x	1	x	0.075	=	2.33	m ²
	1	x	2.20	x	1	x	0.075	=	0.17	m ²
road			35.00	x	2	x	0.075	=	5.25	m ²
road			3.00	x	5	x	0.075	=	1.13	m ²
for tie beam	7	x	5.50	x	2	x	0.10	=	7.70	m ²
For plinth protection	1	x	30.50	x	1	x	0.10	=	3.05	m ²
	2	x	6.95	x	1	x	0.10	=	1.39	m ²
For R.CC below G.L										
For footing	2	x	31.00	x	1	x	0.25	=	7.75	m ²
For footing	2	x	1.70	x	1	x	0.25	=	0.43	m ²
	1	x	31.00	x	1	x	0.25	=	7.75	m ²
	1	x	2.10	x	1	x	0.25	=	0.53	m ²
Foundation beam	1	x	31.00	x	2	x	0.30	=	18.60	m ²
	2	x	31.00	x	2	x	0.30	=	37.20	m ²
	2	x	0.60	x	3	x	0.30	=	1.08	m ²
for column upto tiebeam	14	x	0.30	x	2	x	0.60	=	5.04	m ²
for column upto tiebeam	14	x	0.45	x	2	x	0.60	=	7.56	m ²
upto tiebeam top	7	x	0.30	x	2	x	0.60	=	2.52	m ²
upto tiebeam top	7	x	0.35	x	2	x	0.60	=	2.94	m ²
for tie beam	5	x	5.50	x	2	x	0.40	=	22.00	m ²
for tie beam	2	x	6.95	x	2	x	0.45	=	12.51	m ²
									<u>149.37</u>	m ²
@ Rs.			205.00	/		sq.m			=	Rs. <u>(31129.00)</u>
										<u>30,620.00</u>

(P-30)

10 P-15/item-08

Brick work with 1st class bricks in cement mortar (1:6)

(a) In foundation and plinth

Over Foundation beam	3	x	7.00	x	0.25	x	2.10	=	11.03	m ³
Over Foundation beam	9	x	5.00	x	0.25	x	2.10	=	23.63	m ³
Over Foundation beam	3	x	4.00	x	0.25	x	2.10	=	6.30	m ³
Over Foundation beam	3	x	2.40	x	0.25	x	2.10	=	3.78	m ³
Over Tie beam	7	x	4.60	x	0.25	x	1.30	=	10.47	m ³
Over Tie beam	2	x	1.20	x	0.25	x	1.30	=	0.78	m ³
wbsedcl HT	2	x	2.00	x	0.25	x	0.90	=	0.90	m ³
wbsedcl HT	1	x	3.10	x	0.25	x	0.90	=	0.70	m ³
PWDI HT	1	x	4.10	x	0.25	x	0.90	=	0.92	m ³
PWDI HT	2	x	2.00	x	0.25	x	0.90	=	0.90	m ³
Transformer 2	2	x	2.00	x	0.25	x	0.75	=	0.75	m ³
Transformer 2	1	x	4.10	x	0.25	x	0.90	=	0.92	m ³
Transformer 1	2	x	2.00	x	0.25	x	0.75	=	0.75	m ³
Transformer 1	1	x	4.10	x	0.25	x	0.90	=	0.92	m ³
, LT paneletc	2	x	4.55	x	0.25	x	0.75	=	1.71	m ³
, LT paneletc	1	x	6.10	x	0.25	x	0.75	=	1.14	m ³
							Qty.	=	65.59 65.60	m ³
	@	Rs.	4927.98	/	cum			=	Rs.	(323275.00) ✓ 323,226.00

10.1 b) in super structure ground floor

	2	x	7.00	x	0.25	x	3.90	=	13.65	m ³
	6	x	5.00	x	0.25	x	3.90	=	29.25	m ³
	2	x	4.00	x	0.25	x	3.90	=	7.80	m ³
	1	x	2.40	x	0.25	x	3.90	=	2.34	m ³
	7	x	4.60	x	0.25	x	3.90	=	31.40	m ³
Deduction W& Door	5	x	2.50	x	0.25	x	3.00	=	-9.38	m ³
Top grill	5	x	5.00	x	0.25	x	1.00	=	-6.25	m ³
stair window	1	x	0.90	x	0.25	x	1.50	=	-0.34	m ³
								=	68.47	m ³
	@	Rs.	5150.98	/	cum	=		=	Rs.	(352688.00) ✓ 352,700.00

10.2 in 1st floor:

For stair Room	2	x	4.60	x	0.25	x	2.70	=	6.21	m ³
For stair Room	2	x	2.40	x	0.25	x	2.70	=	3.24	m ³
For Parapet	8	x	5.00	x	0.25	x	0.90	=	9.00	m ³
	2	x	4.00	x	0.25	x	0.90	=	1.80	m ³
	1	x	6.95	x	0.25	x	0.90	=	1.56	m ³
	1	x	1.20	x	0.25	x	0.90	=	0.27	m ³
								=	22.08	m ³
add extra Rs.111.00/m3	@	Rs.	5261.98	/	m ³	=		=	Rs.	(116185.00) ✓ 116,204.00

11 P-16/item-16

125 mm. thick brick work with 1st class bricks in cement mortar (1:4) in ground floor.

Ground floor

for verandah	1	x	7.00	x	1	x	0.90	=	6.30	m ²
for verandah	3	x	5.00	x	1	x	0.90	=	13.50	m ²
for verandah	1	x	4.00	x	1	x	0.90	=	3.60	m ²
for verandah	1	x	2.40	x	1	x	0.90	=	2.16	m ²
for verandah over lintel	2	x	1.20	x	1	x	0.90	=	2.16	m ²
for verandah	1	x	7.00	x	1	x	1.80	=	12.60	m ²
for verandah	3	x	5.00	x	1	x	1.80	=	27.00	m ²
for verandah	1	x	4.00	x	1	x	1.80	=	7.20	m ²
for verandah	1	x	2.40	x	1	x	1.80	=	4.32	m ²
for verandah	2	x	1.20	x	1	x	1.80	=	4.32	m ²
wbsedcl HT	2	x	2.45	x	1	x	0.90	=	4.41	m ²
wbsedcl HT	1	x	4.00	x	1	x	0.90	=	3.60	m ²
PWDI HT	1	x	5.00	x	1	x	0.90	=	4.50	m ²

(P-31)

PWDI HT	2	x	2.45	x	1	x	0.90	=	4.41	m ²
Transformer 2	2	x	2.45	x	1	x	0.75	=	3.68	m ²
Transformer 2	1	x	5.00	x	1	x	0.90	=	4.50	m ²
Transformer 1	2	x	2.45	x	1	x	0.75	=	3.68	m ²
Transformer 1	1	x	5.00	x	1	x	0.90	=	4.50	m ²
, LT paneletc	2	x	4.10	x	1	x	0.75	=	6.15	m ²
, LT paneletc	1	x	7.00	x	1	x	0.75	=	5.25	m ²
							Qty.	=	127.83	m ²

@ Rs. 677.00 / sq.m = Rs.

(86,548.00) ✓

12 P-47/item-1

25mm. thick damp proof course with cement concrete with stone chips (1:1.5:3) [with graded stone aggregate 10 mm nominal size] and admixture of water proofing compound as per manufacturer's specification followed by two coat of polymer based paint, (1st coat after 4 to 5 days of concrete laying and 2 nd coat just before brick masonry work) as directed (cost of water proofing compound & polymer based paint to be paid separately). (Chequering not required over concrete or painted surface). [Note: - Waterproofing as per item NO 60, polymer based paint as per item 59 (a) of Section (C).

Over Foundation beam	3	x	7.00	x	0.25	x	1	=	5.25	m ²
Over Foundation beam	9	x	5.00	x	0.25	x	1	=	11.25	m ²
Over Foundation beam	3	x	4.00	x	0.25	x	1	=	3.00	m ²
Over Foundation beam	3	x	3.00	x	0.25	x	1	=	2.25	m ²
Over Tie beam	7	x	4.60	x	0.25	x	1	=	8.05	m ²
									29.80	m ²

@ Rs. 194.00 / m2 = Rs. 5,781.00

13 P-189-I-1

Plaster (to wall, floor, ceiling etc.) with sand and cement mortar including rounding off or chamfering corners as directed and raking out joints including throating, nosing and drip course, scaffolding/staging where necessary (Ground floor). [Excluding cost of chipping over concrete surface]

- (i) With 1:6 cement mortar
- (b) 20 mm thick plaster (Out side)

Ground floor

Inside	2	x	7.00	x	1	x	4.40	=	61.60	m ²
	2	x	5.00	x	1	x	4.40	=	44.00	m ²
Inside	2	x	5.00	x	3	x	4.40	=	132.00	m ²
	2	x	5.00	x	3	x	4.40	=	132.00	m ²
	2	x	4.00	x	1	x	4.40	=	35.20	m ²
	2	x	5.00	x	1	x	4.40	=	44.00	m ²
stair	2	x	5.00	x	1	x	4.40	=	44.00	m ²
	1	x	2.40	x	1	x	4.40	=	10.56	m ²
Deduction W& Door ventilator	5	x	2.50	x	1	x	3.00	=	-37.50	m ³
	5	x	5.00	x	1	x	1.00	=	-25.00	m ³
stair window	1	x	0.90	x	1	x	1.50	=	-1.35	m ³
									439.51	m ² (A)

@ Rs. 163.00 / m² = Rs. 71,640.00

1st floor

Mumpty room	1	x	2	x	2.40	x	2.70	=	12.96	m ²
Mumpty room	1	x	2	x	5.00	x	2.70	=	27.00	m ²
For Parapet	1	x	2	x	30.15	x	0.90	=	54.27	m ²
	1	x	2	x	6.95	x	0.90	=	12.51	m ²
									106.74	m ² (B)

@ Rs. 167.00 / m² = Rs. 17,826.00

(c) 15 mm thick plaster, Ground floor

Out side GI to PL	1	x	30.15	x	2	x	1.20	=	72.36	m ²
	1	x	6.95	x	2	x	1.20	=	16.68	m ²
up to roof	1	x	30.15	x	1	x	4.50	=	135.68	m ²
	1	x	30.15	x	1	x	4.65	=	140.20	m ²
125 mm B/W for verandah	1	x	30.15	x	2	x	0.90	=	54.27	m ²
for verandah	1	x	30.15	x	2	x	3.30	=	198.99	m ²

Less for window & Door ventilator = (37.5 + 25 + 1.35)

= 63.85 m

(554.33 m)

(P-32)

B.F = 554.33 ✓

wbsedcl HT	2	x	2.00	x	1	x	0.90	=	3.60	m ²
wbsedcl HT	1	x	3.10	x	1	x	0.90	=	2.79	m ²
wbsedcl HT	2	x	2.45	x	1	x	0.90	=	4.41	m ²
wbsedcl HT	1	x	4.00	x	1	x	0.90	=	3.60	m ²
PWDI HT	1	x	5.00	x	1	x	0.90	=	4.50	m ²
PWDI HT	2	x	2.45	x	1	x	0.90	=	4.41	m ²
PWDI HT	1	x	4.10	x	1	x	0.90	=	3.69	m ²
PWDI HT	2	x	2.00	x	1	x	0.90	=	3.60	m ²
Transformer 2	2	x	2.00	x	1	x	0.75	=	3.00	m ²
Transformer 2	1	x	4.10	x	1	x	0.75	=	3.08	m ²
Transformer 2	1	x	5.00	x	1	x	0.90	=	4.50	m ²
Transformer 2	2	x	2.45	x	1	x	0.90	=	4.41	m ²
Transformer 1	2	x	2.45	x	1	x	0.75	=	3.68	m ²
Transformer 1	1	x	5.00	x	1	x	0.75	=	3.75	m ²
Transformer 1	1	x	4.10	x	1	x	0.90	=	3.69	m ²
Transformer 1	2	x	2.00	x	1	x	0.90	=	3.60	m ²
, LT paneletc	1	x	6.10	x	1	x	0.75	=	4.58	m ²
, LT paneletc	2	x	4.55	x	1	x	0.75	=	6.83	m ²
, LT paneletc	1	x	7.00	x	1	x	0.75	=	5.25	m ²
, LT paneletc	2	x	5.00	x	1	x	0.75	=	7.50	m ²
							Qty. =		566.93 638.80	m ² (C)
@ Rs.			142.00 /		m ²	=			=	Rs. (90710.00)

(90710.00) ✓
~~80,503.00~~

1st floor										
Mumpty room	2	x	5.00	x	2.70	=	27.00	m ²		
Mumpty room	2	x	2.40	x	2.70	=	12.96	m ²		
For Parapet										
up to roof	1	x	30.15	x	2	x	1.15	=	69.35	m ²
	1	x	6.95	x	2	x	1.15	=	15.99	m ²
									125.29	m ² (D)
@ Rs.			146.00 /		m ²	=			=	Rs. 18,292.00

(ii) With 1:4 cement mortar (c) 10 mm thick plaster

Ground floor										
Celing	1	x	7.00	x	5.00	=	35.00	m ²		
	3	x	5.00	x	5.00	=	75.00	m ²		
	1	x	5.00	x	4.00	=	20.00	m ²		
	1	x	30.15	x	1.20	=	36.18	m ²		
For stair	2	x	4.75	x	1.20	=	11.40	m ²		
For stair landing	1	x	2.40	x	1.20	=	2.88	m ²		
Tread & Riser	15	x	1.20	x	0.30	=	5.40	m ²		
Tread & Riser	15	x	1.20	x	0.15	=	2.70	m ²		
chajja	2	x	30.15	x	0.45	=	27.14	m ²		
						Qty. =	215.70	m ² (E)		
@ Rs.			127.00 /		m ²	=			=	Rs. (27,392.00)

(27,392.00) ✓

14 P-192-I -15

Neat cement punning about 1.5mm thick in wall,dado,window sill,floor etc. NOTE:Cement 0.152 cu.m per100 sq.m.
For outside dado(GL to PL) Ground Floor

Out side GI to PL	1	x	30.15	x	2	x	1.20	=	72.36	m ²
	1	x	6.95	x	2	x	1.20	=	16.68	m ²
Inside	2	x	7.00	x	1	x	0.30	=	4.20	m ²
	6	x	5.00	x	1	x	0.30	=	9.00	m ²
	2	x	4.00	x	1	x	0.30	=	2.40	m ²
	2	x	3.00	x	1	x	0.30	=	1.80	m ²
	7	x	5.00	x	1	x	0.30	=	10.50	m ²
									116.94	m ² (G)
@ Rs.			34.00 /		sq.m	=			=	Rs. 3,976.00

(P-33)

15 P-196/item-8

Applying Exterior grade Acrylic primer of approved quality and brand on plastered or concrete surface old or new surface to receive decorative textured(matt finish) or smooth finish acrylic exterior emulsion paint including scraping and preparing the surface thoroughly, complete as per manufacturer's specification and as per direction of the EIC.

in ground floor:(a) One Coats

up to roof	1	x	30.15		x	2	x	5.40	=	325.62	m ²		
	1	x	6.95		x	2	x	5.40	=	75.06	m ²		
									=	400.68	m ² (M)		
	@	Rs.	3140.00	/	%m ²				=	Rs.	12,581.00		

1st floor

Mumpty room	2				x	5.00		x	2.70	=	27.00	m ²	
Mumpty room	2				x	2.40		x	2.70	=	12.96	m ²	
up to roof	1	x	30.15		x	2	x	1.15	=	69.35	m ²		
	1	x	6.95		x	2	x	1.15	=	15.99	m ²		
									=	125.29	m ² (N)		
	@	Rs.	3211.00	/	%m ²				=	Rs.	4,023.00		

16 P-197/item-17(a)

Protective and Decorative Acrylic exterior emulsion paint of approved quality, as per manufacturer's specification and as per direction of EIC to be applied over acrylic primer as required. The rate includes cost of material, labour, scaffolding and all incidental charges but excluding the cost of primer.

in ground floor:(Two coat)

a) Normal Acrylic Emulsion

	Qty same as Mkd-M								=	400.68	m ²		
	@	Rs.	67.00	/	m ²				=	Rs.	26,846.00		
1st floor	Qty same as Mkd-N								=	125.29	m ²		
	@	Rs.	67.71	/	m ²				=	Rs.	8,483.00		

17 P-196/item-10

Acrylic Distemper to interior wall, ceiling with a coat of solvent based interior grade acrylic primer (as per manufacturer's specification) including cleaning and smoothening of surface.Two Coats

Qty same as SI no-13 mkd-(A)									=	439.51	m ²		
Qty same as SI no-13 mkd-(B)									=	106.74	m ²		
Qty same as SI no-13 mkd-(E)									=	215.70	m ²		
									=	761.95	m ²		
									=	761.95	m ²		
	@	Rs.	70.00	/	m ²				=	Rs.	53,336.00		

18 P-192/item-1

Labour for Chipping of concrete surface before taking up Plastering work.

Area (A+B)									=	582.55	581.52 +	39.54	=	622.10	621.06	m ²		
	@	Rs.	21.00	/	m ²				=	Rs.	13,042.00							

19 P-104/item-13

(a) M.S.or W.I. Ornamental grill of approved design joints continuously welded with M.S, W.I. Flats and bars of windows, railing etc. fitted and fixed with necessary screws and lugs in ground floor.(i) Grill weighing above 10 Kg./sq.mtr and up to 16 Kg./sq.

varandah	5				x	4.50		x	1.20	=	27.00	m ²	
Door top	5				x	5.00		x	1.00	=	25.00	m ²	
window	1				x	0.90		x	1.50	=	1.35	m ²	
door	1				x	2.00		x	2.10	=	4.20	m ²	
									=	57.55	52.00	m ²	
	@	Rs.	14.00	/	Kg/m ²				=	728.00	Kg		805.7 kg.
									=	7.28	Qntl		8.100
	@	Rs.	9888.00	/	Qntl				=	Rs.	71,985.00		
1st floor									=	2.1	m ²		
Stair	1				x	1.00		x	2.10	=	2.10	m ²	
	@	Rs.	14.00	/	Kg/m ²				=	29.40	Kg		Qty. 0.29 qntl.

(P-34)

0.29 Qntl = Rs. (2896.00) m
2,928.00

20 P-105/item-15

Supplying 1.5mm thick M.S. sheet fitted and fixed on one or both faces of M.S./ W.I. gate etc. with point welding at not more than 150mm apart complete in all respect as per design including cost of all labour and materials

Stair	1		x 1.00	x 2.10	=	2.10 m ²
						<u>2.10 m²</u>

@ Rs. 1304.00 / ~~9960.00~~ m² = Rs. (2738.00) m
2,360.00

21 P-106/item-19 (b)

b) Supplying fitting and fixing steel rolling grills link type, shutter with 18 B.G .of approved type steel to the section 75mm wide, fitted with coil wire spring to necessitate the fitting of required Nos. of C.I. Pulleys on heavy type solid drawn seamless steel tube complete with locking arrangements both inside and outside specially builtup side guide channels including providing a hood for the steel rolling shutter in the room, painting two coats of approved aluminium paint over a coat of red lead primer complete (Measurement will be made on the area of opening covered by the rolling shutter corrected upto 2 decimal)

1 X	5	X	2.50 X	3.00 =	37.50 m ²
-----	---	---	--------	--------	----------------------

@ Rs. 4282.00 / m² = Rs. 160,575.00

22 P-205/item-01

Supplying best Indian sheet glass panes set in putty and fitted and fixed with nails and putty complete. (In all floors for internal wall & upto 6 m height for external wall)(ii) 4 mm thick

W8	1		x 0.90	x 1.50	=	1.35 m ²
						<u>1.35 m²</u>

@ Rs. 536.00 / m² = Rs. 724.00

23 P-200/item-1

(b) Priming one coat on steel or other metal surface with synthetic oil bound primer of approved quality including smoothing surfaces by sand papering etc.

varandah	5		x 4.50	x 1.20	=	27.00 m ²
Door top	5		x 5.00	x 1.00	=	25.00 m ²
window	1		x 0.90	x 1.50	=	1.35 m ²
door	1		x 2.00	x 2.10	=	4.20 m ²
Stair	1		x 1.00	x 2.10	=	2.1 m ²
Stair	1		x 1.00	x 2.10	=	2.1 m ²

2.6 X	5	X	2.50 X	3.00 =	97.50 m ²
					<u>159.25 m²</u>

@ Rs. 29.00 / m² = Rs. 4,618.00

24 P-200/item-2

(A) Painting with best quality synthetic enamel paint of approved make and brand including smoothing surface by sand papering etc. including using of approved putty etc. on the surface, if necessary ;(b) On steel or other metal surface : With super gloss (hi-gloss) -(b) On steel or other metal surface :
(iv) Two coats (with any shade except white)

varandah	5		x 4.50	x 1.20	=	27.00 m ²
Door top	5		x 5.00	x 1.00	=	25.00 m ²
window	1		x 0.90	x 1.50	=	1.35 m ²
door	1		x 2.00	x 2.10	=	4.20 m ²
Stair	1		x 1.00	x 2.10	=	2.1 m ²
Stair	1		x 1.00	x 2.10	=	2.1 m ²

2.6 X	5	X	2.50 X	3.00 =	97.50 m ²
					<u>159.25 m²</u>

@ Rs. 79.00 - 81.00 / m² = Rs. (12581.00) m
12,899.00

(P-35)

25 P-212/item-21

Supplying, fitting & fixing UPVC pipes A-Type and fittings conforming to IS:13592- 1992 with all necessary clamps nails including making holes in walls, floor etc. cutting trenches in any soil through masonry concrete structures etc if necessary and mending good damages including joining with jointing materials (Spun Yarn, Valamoid/Bitumen/M-Seal etc) complete.A)

UPVC Pipes:
(iii) 110 mm. Dia. @ Rs. 251.00 / mtr x 4.50 x 1 = ~~12.50~~ ^{27.00} mtr = Rs. ~~3,389.00~~ ^(6777.00) ✓

B) UPVC Fittings:

a) Plain Tee

(ii) 110 mm. Dia. @ Rs. 172.00 / Nos = ~~3.00~~ ^{6.00} Nos = Rs. ~~516.00~~ ^(1032.00) ✓

D)shoe

(ii) 110 mm. Dia. @ Rs. 111.00 / Nos = ~~3.00~~ ^{6.00} Nos = Rs. ~~333.00~~ ^(666.00) ✓

26 P-4/item-7

Bailing or pumping out water from foundation trenches.

for foudation 1 X 31.00 x 1.80 x 1.20 = 66.96 m³
1 X 31.00 x 2.20 x 1.20 = 81.84 m³
148.80 m³

@ Rs. 2088.00 /% m3 = = Rs. 3,107.00

27 P-2/item-5

Earth work in filling in compound, tank, low land, ditches etc. with good earth, in layers not exceeding 150 mm. including breaking clods and consolidating the same by ramming and dressing complete. (Payment will be made on profile measurement before and after the work)(b) (i) With carried earth arranged by the contractor within a radius of 3 km. including cost of carried earth.

1 x 40.00 ~~37982.00~~ ^{41958.00} x 8.00 x 0.40 = 128 m³
@ Rs. 41958.00 /% m³ = = Rs. ~~53,796.00~~ ^(48617.00) ✓

28 P-1/item-1

Surface Dressing of the ground in any kind of soil including removing vegetation inequalities not exceeding 15 cm depth and disposal of the rubbish within a lead upto 75 m as directed

1 x 40.00 x 8.00 x 1 = 320 m²
@ Rs. 10.00 / sq.m = Rs. 3,200.00

29 P-99/item-1

M.S. structural works in columns, beams etc.with simple rolled structural members (e.g. joists, angle, channel sections conforming to IS: 226, IS: 808 & SP (6)- 1964 connected to one another with bracket, gussets, cleats as per design, direction of Engineer-in- charge complete including cutting to requisite shape and length, fabrication with necessary bolting, metal arc welding conforming to IS:816- 1956 & IS: 1995 using electrodes of approved make dbrandconforming to IS:814- 1957, haulage, hoisting and erection all complete. The rate includes the cost of rolled steel section, onsumables such as electrodes, gas and hire charge of all tools and plants and labour required for the work including all incidental chages such as electricity charges, labour insurance charges etc.I) For structural members of specifiedsections weighing not less than 22.5 Kg./m

angle 45x45x6mm 2 x 5 x 1 x 5.00 = 50.00 M
4 x 5 x 1 x 4.10 = 82.00 M
132.00 M
@ 4.00 / M = 0.528 M.T

chequre Plate
wbsedcl HT 2 x 2.00 x 1 x 0.825 = 3.30 m²
wbsedcl HT 1 x 4.00 x 1 x 0.825 = 3.30 m²
PWDI HT 1 x 5.00 x 1 x 0.825 = 4.13 m²
PWDI HT 2 x 2.00 x 1 x 0.825 = 3.30 m²
Transformer 2 2 x 2.00 x 1 x 0.825 = 3.30 m²
Transformer 2 1 x 5.00 x 1 x 0.825 = 4.13 m²
Transformer 1 2 x 2.00 x 1 x 0.825 = 3.30 m²
Transformer 1 1 x 5.00 x 1 x 0.825 = 4.13 m²
. LT paneletc 2 x 4.55 x 1 x 0.825 = 7.51 m²
. LT paneletc 1 x 7.00 x 1 x 0.825 = 5.78 m²

(P-36)

@ 55.00 / m² = 2.319 M.T
 Total = 0.528 + 2.32 = 2.847 M.T
 @ Rs. 72603.00 / M.T = Rs.

(206701.00) ✓
 168,342.00

30 P-100/item-2

M.S. structural works in roof trusses with tubular sections conforming to IS: 806-1957 & IS: 1161- 1958 connected to one another with bracket, gusset cleats as per design, direction of Engineer-in-charge complete including cutting to requisite size, fabrication with necessary metal arc welding conforming to IS: 816-1956 & IS: 9595 using electrodes of approved make and brand conforming to IS:814- 1957, haulage, hoisting and erection all complete The rate includes the cost of rolled steel section, consumables such as electrodes, gas and hire charge of all tools and plants and labour required for the work including all incidental charges such as electricity charges, labour insurance charges etc. Payment to be made on the basis of calculated weight of structural tubular members as specified in relevant IS code in finished work. Payment for gusset, bracket, cleat may be made by adding the actual weight of such items with weight of finished structural members. The rates are considered for a height of erection 8 m. /2nd floor level from the ground. Add 1.5 % extra over the rate for each additional floor or 4m. beyond the initial 8 m. or part thereof.

i) For trusses spanning up to 12.00 m
 1 x 4 x 2.40 = 9.60 M
 1 x 4 x 6.00 = 24.00 M
 33.60 m
 @ 6.00 / M = 0.202 M.T
 @ Rs. 72951.00 / M.T = Rs.

(14736.00) ✓
 14,707.00

31 P-82/item-14

Supplying, fitting & fixing Zn-Al alloy (55% Al & 45% Zn) coating of 150 grams per sq. metre (followed by colour coated on both side) steel sheet work having minimum yield strength of 550 Mpa of trapezoidal profile of approved make (excluding the supporting frame work) fitted and fixed with 55 mm & 25 mm self tapping screw, EPDM Washer 16 mm dia & 3 mm th. washer etc. complete with 150 mm end lap and one corrugation minimum side lap. (Payment to be made on area of finished work). (i) In Roof:- a) With 0.5 mm thick sheet

1 x 3.00 x 6.00 = 18 m²
 18.00 m²
 @ Rs. 896.00 / m² = Rs. 16,128.00

32 P-48/item-6

Artificial stone in floor, dado, staircase etc with cement concrete (1:2:4) with stone chips, laid in panels as directed with topping made with ordinary or white cement (as necessary) and marble dust in proportion (1:2) including smooth finishing and rounding off corners including raking out joints or roughening of concrete surface and application of cement slurry before flooring works using cement @ 1.75 kg/sq.m all complete including all materials and labour. In ground floor. 3 mm. thick topping (High polishing grinding on this item is not permitted with ordinary cement). Using grey cement (iii) 35 mm. thick

1 x 30.15 x 6.20 = 186.93 m²
 186.93 m²
 @ Rs. 322.00 / m² = Rs. 60,191.00
 264.00

(60191.00) ✓
 49,350.00

33 P-52/item-13

Supplying dividing strip fitted and fixed with cement mortar (1:3) in mosaic or patent stone floor, dado etc. complete as per direction of the Engineer-in-charge. (i) Glass - 3mm. thick (b) 25 mm. wide strip

4 x 45.00 x 1 = 180 m
 180.00 m
 @ Rs. 18.00-19.00 / m = Rs. 3,240.00

3240.00
 3,420.00
 Total= 4,017,570.00 49,94,198.00
 add 12% GST= 482,108.00 53,93,090.00
 Total including GST= 4,499,678.00 50,33,502.00
 Add 1% cess= 44,997.00 50,335.00
 Add 3% GST= 134,990.00 1,51,005.00
 Total= Rs. 4,679,665.00 (52,34,842.00) ✓

(P-37)

Junior Engineer, PWD
 Jangipur Sub-Division

Assistant Engineer, PWD
 Jangipur Sub-Division

Executive Engineer
 Berhampore Division No.I, PWD

Block Medical Officer of Health
 Anupnagar B. P. H. C.
 Dhulyan, Murshidabad
 19/12/2018

Chief Medical Officer of Health
 Murshidabad

Schematic Diagram of Proposed Substation at Jangipur Sub Division Hospital, in the District of Murshidabad.

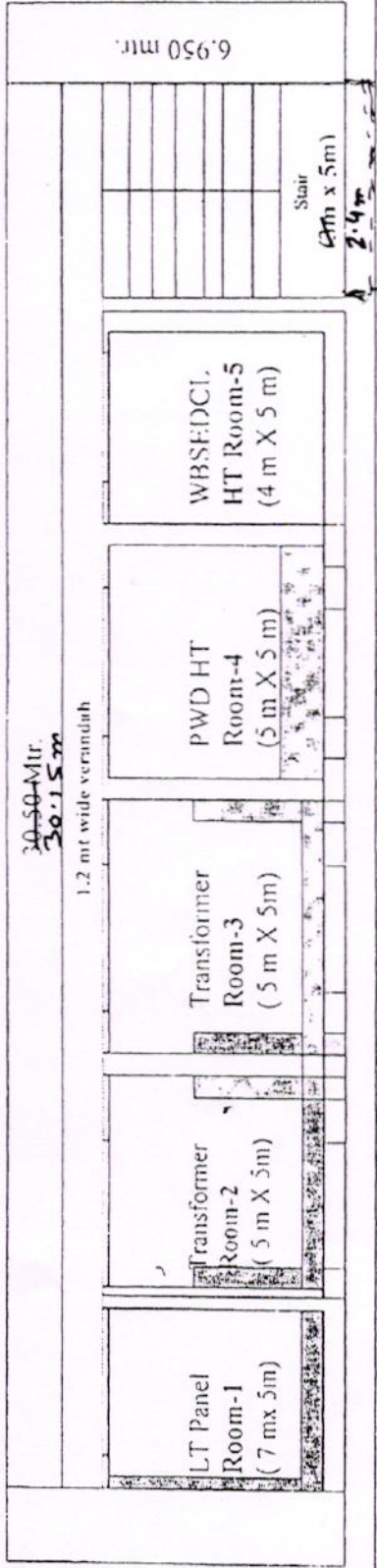

Note

1. Foundation-suitable for 2 storied building.
2. Floor to ceiling height-4.5m.
3. Floor level-1.20m above ground level.
4. 3m wide approach road in front of the Substation building for loading/unloading Substation equipments and passage for fire fighting car.
5. Partition wall-30cm thick brick
6. 1.2m wide verandah in front side.
7. Rolling shutter 2.5m wide, 3 meter height with ventilation grill on top portion
8. Heavy duty steel ladder with side railing up to substation roof, for roof drainage maintenance
9. V-Circular hole dia 20" on wall at 4m height, for fixing exhaust fan.
10. Measurement of Cable trench-
 - WBSE/DCI and PWD HT room-600mm width, 900mm depth
 - Transformer room-1
 - 460mm width, 900mm depth for HT cable
 - 460mm width, 750mm depth for LT cable
 - Transformer room-2
 - 460mm width, 900mm depth for HT cable.
 - 460mm width, 750mm depth for LT cable
 - LT panel room - 460mm width, 750mm depth
11. Room No. 2,3,4 & 5 must be in the Gr. Floor. Remaining room i.e L.T Room, may be constructed UPSTAIRS.
12. The dimension of Existing Gate must be minimum 20 Ft. wide for entrance of Truck.

APR 11 11 19 08

(5)

28/09/18

28/09/18

(P-38)

Executive Engineer, PWD
Murshidabad Electrical Division

Chief Medical Officer of Health
Murshidabad

Assistant Engineer PWD
Jangipur Sub-Division

(SL NO-21)

Construction of 125 kva D.G shade Proposed Construction of of G+3 Storied Mother and Child Hub at the premises of Anupnagar BPHC, Samsrganj Block, Murshidabad during the year 2018-19

1 P-1/item-2

Earth work in excavation of foundation trenches or drains, in all sorts of soil (including mixed soil but excluding laterite or sandstone) including removing, spreading or stacking the spoils within a lead of 75 m. as directed. The item includes necessary trimming the sides of trenches, levelling, dressing and ramming the bottom, bailing out water as required complete. a) depth of excavation not exceeding 1500mm

for foudation	2	x	6.00	x	0.50	x	0.45	=	2.70	m ³
for foudation	2	x	2.60	x	0.50	x	0.45	=	1.17	m ³
for Ramp	2	x	6.00	x	0.50	x	0.45	=	2.70	m ³
									<u>6.57</u>	m ³

@ Rs. 11927.00 / %cum = Rs. 784.00

2 P-2/item-4(B)

Filling in foundation or plinth by silver sand in layers not exceeding 150 mm as directed and consolidating the same by thorough saturation with water, ramming complete including the cost of supply of sand. (payment to be made on measurement of finished quantity) b) do by fine sand

for foudation	2	x	6.00	x	0.50	x	0.15	=	0.90	m ³
	2	x	2.60	x	0.50	x	0.15	=	0.39	m ³
	1	x	5.50	x	2.55	x	0.50	=	7.01	m ³
for Ramp	2	x	6.00	x	0.50	x	0.15	=	0.90	m ³
								=	<u>9.20</u>	m ³

@ Rs. 71181.00 / %cum = Rs.

(6549-00) ✓
~~6,550.00~~

3 P-14/item-1

Single Brick Flat Soling of picked jhama bricks including ramming and dressing bed to proper level and filling joints with local sand.

for foudation	2	x	6.00	x	0.50	x	1	=	6.00	m ²
	2	x	2.60	x	0.50	x	1	=	2.60	m ²
For floor	1	x	5.50	x	2.55	x	1	=	14.03	m ²
For floor of ramp	1	x	6.00	x	1.80	x	1	=	10.80	m ²
for Ramp	2	x	6.00	x	0.50	x	1	=	6.00	m ²
									<u>39.43</u>	m ²

@ Rs. 326.00 / sq.m = Rs.

(12859-00) ✓
~~12,853.00~~

4 P-47/item-3

Supplying and laying Polythene Sheet (150gm / sq.m.) over damp proof course or below flooring or roof terracing or in foundation or in foundation trenches.

for foudation	2	x	6.00	x	0.50	x	1	=	6.00	m ²
	2	x	2.60	x	0.50	x	1	=	2.60	m ²
	1	x	5.50	x	2.55	x	1	=	14.03	m ²
For floor ofn ramp	1	x	6.00	x	1.80	x	1	=	10.80	m ²
for Ramp	2	x	6.00	x	0.50	x	1	=	6.00	m ²
									<u>39.43</u>	m ²

@ Rs. 24.00 / sq.m = Rs. 946.00

5 P-34/item-22 A

(I) Cement concrete with graded stone ballast (40 mm size excluding shuttering) In ground floor (A) [Pakur Variety](a) 1:3:6 proportion

for foudation	2	x	6.00	x	0.50	x	0.15	=	0.90	m ³
	2	x	2.60	x	0.50	x	0.15	=	0.39	m ³
	1	x	6.00	x	3.00	x	0.15	=	2.70	m ³
For floor ofn ramp	1	x	6.00	x	1.80	x	0.15	=	1.62	m ³
for Ramp	2	x	6.00	x	0.50	x	0.15	=	0.90	m ³
									<u>6.51</u>	m ³

@ Rs. 5188.93 / cum = Rs. 33,780.00

(P-44/16)

6 P-15/item-8

Brick work with 1st class bricks in cement mortar (1:6)

(a) In foundation and plinth

Foundation

for foudation	2	x	6.00	x	0.375	x	0.15	=	0.68	m ³
	2		2.60	x	0.375	x	0.15	=	0.29	m ³
for Ramp	2	x	6.00	x	0.375	x	0.15	=	0.68	m ³
for foudation up to G.L	2	x	6.00	x	0.250	x	0.15	=	0.45	m ³
	2		2.60	x	0.250	x	0.15	=	0.20	m ³
for Ramp	2	x	6.00	x	0.250	x	0.15	=	0.45	m ³
for foudation up to G.L	2	x	6.00	x	0.250	x	0.60	=	1.80	m ³
	2		2.60	x	0.250	x	0.60	=	0.78	m ³
for Ramp	2	x	6.00	x	0.250	x	0.30	=	0.90	m ³

Qty. = 6.23 m³

@ Rs. 4927.98 / cum

= Rs.

(30701.00) ✓
30,640.00

7 P-189/item-1

Plaster (to wall, floor, ceiling etc.) with sand and cement mortar including rounding off or chamfering corners as directed and raking out joints including throating, nosing and drip course, scaffolding/staging where necessary (Ground floor). [Excluding cost of chipping over concrete surface] (i) With 1:6 cement mortar

(c) 15 mm thick plaster, Ground floor

Out side Gl to PL	6.00	x	0.750	x	2	=	9.00	m ²
	2.60	x	0.750	x	2	=	3.90	m ²
for Ramp	6.00	x	0.350	x	2	=	4.20	m ²

Qty. = 17.10 m²

@ Rs. 142.00 / m²

= Rs.

2,428.00

8 P-104/item-13

(a) M.S. or W.I. Ornamental grill of approved design joints continuously welded with M.S. W.I. Flats and bars of windows, railing etc. fitted and fixed with necessary screws and lugs in ground floor.

(i) Grill weighing above 10 Kg./sq.mtr and up to 16 Kg./sq. mtr.

	2	x	6.00	x	3.00	=	36.00	m ²
	2	x	3.00	x	3.00	=	18.00	m ²

54.00 m²

@ 14.00 / Kg/m² = 756.00 Kg

Qty. = 7.56 Qntl

@ Rs. 9888.00 / Qntl =

= Rs.

74,753.00

9 P-200/item-1

(b) Priming one coat on steel or other metal surface with synthetic oil bound primer of approved quality including smoothening surfaces by sand papering etc.

For grill	2	x	6.00	x	3.00	=	36.00	m ²
	2	x	3.00	x	3.00	=	18.00	m ²
For M.S Pipe	1	x	52.20	x	0.24	=	12.53	m ²

66.53 m²

@ Rs. 29.00 / m²

= Rs.

1,929.00

10 P-200/item-2

(A) Painting with best quality synthetic enamel paint of approved make and brand including smoothening surface by sand papering etc. including using of approved putty etc. on the surface, if necessary. (b) On steel or other metal surface :With super gloss (hi-gloss) - (iv) Two coats (with any shade except white)

	2	x	6.00	x	3.00	=	36.00	m ²
	2	x	3.00	x	3.00	=	18.00	m ²
For M.S Pipe	1	x	52.20	x	0.24	=	12.53	m ²

66.53 m²

@ Rs. 79.00 / m²

= Rs.

5,256.00

(P-45/16)

11 P-100/item-2

M.S. structural works in roof trusses with tubular sections conforming to IS: 806-1957 & IS: 1161- 1958 connected to one another with bracket, gusset cleats as per design, direction of Engineer-in-charge complete including cutting to requisite size, fabrication with necessary metal arc welding conforming to IS: 816-1956 & IS: 9595 using electrodes of approved make and brand conforming to IS:814- 1957, haulage, hoisting and erection all complete. The rate includes the cost of rolled steel section, consumables such as electrodes, gas and hire charge of all tools and plants and labour required for the work including all incidental charges such as electricity charges, labour insurance charges etc. Payment to be made on the basis of calculated weight of structural tubular members as specified in relevant IS code in finished work. Payment for gusset, bracket, cleat may be made by adding the actual weight of such items with weight of finished structural members. The rates are considered for a height of erection 8 m. /2nd floor level from the ground. Add 1.5 % extra over the rate for each additional floor or 4m. beyond the initial 8 m. or part thereof. For trusses spanning up to 12.00 m

2	x	3	x	3.60	=	21.60	M
1	x	3	x	6.60	=	19.80	M
1	x	3	x	3.60	=	10.80	M
						<u>52.200</u>	m
	@	6.00	/	M	=	0.3132	M.T

@ Rs. 72951.00 / M.T = Rs. 22,848.00

12 P-82/item-14

Supplying, fitting & fixing Zn-Al alloy (55% Al & 45% Zn) coating of 150 grams per sq. metre (followed by colour coated on both side) steel sheet work having minimum yield strength of 550 Mpa of trapezoidal profile of approved make (excluding the supporting frame work) fitted and fixed with 55 mm & 25 mm self tapping screw, EPDM Washer 16 mm dia & 3 mm th. washer etc. complete with 150 mm end lap and one corrugation minimum side lap. (Payment to be made on area of finished work). (i) In Roof:-a) With 0.5 mm thick sheet

1	x	6.60	x	3.60	=	23.76	m ²
						<u>23.76</u>	m ²

@ Rs. 896.00 / m² = Rs. 21,289.00

13 P-48/item-6

Artificial stone in floor, dado, staircase etc with cement concrete (1:2:4) with stone chips, laid in panels as directed with topping made with ordinary or white cement (as necessary) and marble dust in proportion (1:2) including smooth finishing and rounding off corners including raking out joints or roughening of concrete surface and application of cement slurry before flooring works using cement @ 1.75 kg/sq.m all complete including all materials and labour. In ground floor. 3 mm. thick topping (High polishing grinding on this item is not permitted with ordinary cement). Usina arev cement (ii) 25 mm. thick

1	x	6.00	x	3.00	=	18.00	m ²
1	x	6.00	x	1.80	=	10.80	m ²
						<u>28.80</u>	m ²

@ Rs. 264.00 / m² = Rs. 7,603.00

14 P-192/item-15

Neat cement punning about 1.5mm thick in wall, dado, window sill, floor etc. NOTE: Cement 0.152 cu.m per 100

Out side GI to PL	6.00	x	0.750	x	2	=	9.00	m ²
Out side GI to PL	2.60	x	0.750	x	2	=	3.90	m ²
for Ramp	6.00	x	0.350	x	2	=	4.20	m ²
							<u>17.10</u>	m ²

@ Rs. 34.00 / sq.m = Rs. 581.00

TOTAL (A)	222240.00	222301.00
Add 12% GST on "A", (B)=	26669.00	26676.00
civil work excluding cess (C), SUM OF "A+B"=	248909.00	248977.00
Add 1% cess on (C), D=	2489.00	2490.00
f civil work including cess (E), SUM OF "C+D"=	251398.00	251467.00
Add 3% contingency on (C)=	7467.00	7469.00
GRAND TOTAL=	258865.00	258936.00

(P-45/46)

[Signature]
25-09-18

Junior Engineer, Sec-III PWD, Jangipur Sub-Division

[Signature]
25/09/18

Assistant Engineer PWD Jangipur Sub-Division

[Signature]
25/09/18

Executive Engineer Berhampore Division No.I, PWD

[Signature]
19/12/2018

Block Medical Officer of Health Anupnagar B. P. H. C. Dhuluiyan, Murshidabad

[Signature]
Chief Medical Officer of Health Murshidabad

(SL NO - 20)

Pump Room over under ground reservoir Proposed Construction of of G+3 Storied Mother and Child Hub at the premises of Anupnagar BPHC, Samserganj Block, Murshidabad during the year 2018-19

1 P-25/item-6(b)

Controlled Cement concrete with well graded stone chips (20 mm nominal size) excluding shuttering and reinforcement with complete design of concrete as per IS : 456 and relevant special publications, submission of job mix formula after preliminary mix design after testing of concrete cubes as per direction of Engineer- in charge. Consumption of cement will not be less than 300 Kg of cement with Super plasticiser per cubic meter of controlled concrete but actual consumption will be determined on the basis of preliminary test and job mix formula. In ground floor and foundation. [using concrete mixture](b) M 25 Grade(i) Pakur Variety Ground Floor

roof slab	1	X	5.50	x	6.50	x	0.125	=	4.47	m ³
beam	3	X	5.50	x	0.25	x	0.35	=	1.44	m ³
beam	2	X	6.50	x	0.25	x	0.35	=	1.14	m ³
lintel	2	X	6.50	x	0.25	x	0.15	=	0.49	m ³
lintel	2	X	5.50	x	0.125	x	0.15	=	0.21	m ³
									<u>7.74</u>	m ³
									7.74	

@ Rs. 5976.27 / cum = Rs. 46,279.00

2 P-43/item-40

Reinforcement for Reinforced concrete work in all sorts of structure in/c distribution bars, stirrups, binders etc in/c supply of rods initial straightening and removal of loose rust (if necessary) cutting to requisite length, hooking and bending to correct shape, placing in proper position and binding with 16 gauge black annealed wire at every intersection comp as per drawing and direction. a) for works in foundation, basement and upto roof of g/floor / upto 4m.

i) for steel/mild steel SAIL/TATA/RINL

in ground floor:	7.74	x	0.012	x	7.85	=	0.729	MT	
(@1.2% of concrete volume)							0.729	MT	
							Qty. =	0.729	MT
								1.000	

@ Rs. 70215.85 / MT = Rs. 51,220.00

3 P-42/item-36

Hire and labour charges for shuttering with centering and necessary staging upto 4 m using approved stout props and thick hard wood planks of approved thickness with required bracing for concrete slabs, beams and columns, lintels curved or straight including fitting, fixing and striking out after completion of works (upto roof of ground floor)

(c) Steel shuttering or 9 to 12 mm thick approved quality ply board shuttering in any concrete work

roof slab	1	X	5.50	x	1	x	6.50	=	35.75	m ²
beam	3	X	5.50	x	2	x	0.35	=	11.55	m ²
beam	2	X	6.50	x	2	x	0.35	=	9.10	m ²
lintel	2	X	5.50	x	2	x	0.15	=	3.30	m ²
lintel	2	X	6.50	x	2	x	0.15	=	3.90	m ²
lintel	1	X	1.80	x	1	x	0.25	=	0.45	m ²
lintel	3	X	1.80	x	1	x	0.25	=	1.35	m ²
							Qty. =	<u>65.40</u>	m ²	

@ Rs. 365.00 / sq.m = Rs. 23,871.00

4 P-15/item-08

Brick work with 1st class bricks in cement mortar (1:6)(a) In foundation and plinth

b) in super structure ground floor

P.L to roof	2	x	6.50	x	0.25	x	3.20	=	10.40	m ³
P.L to roof	2	x	5.00	x	0.25	x	3.20	=	8.00	m ³
Deduction & Door	1	x	0.90	x	0.25	x	2.10	=	-0.47	m ³
Deduction W	3	x	1.20	x	0.25	x	1.35	=	61.25	m ³
									<u>47.52</u>	m ³
									16.715	m ³

@ Rs. 4927.98 / cum = Rs. 86,351.00

(P-39)

5 P-16/item-16

125 mm. thick brick work with 1st class bricks in cement mortar (1:4) in ground floor.(i)Ground Floor

parapet	1 x	2 X	6.50 x	0.30	=	3.90	m ²
	1 x	2.0 X	5.50 x	0.30	=	3.30	m ²
					Qty. =	7.20	m ²

@ Rs. 677.00 / sqm = Rs. 4,874.00

6 P-189/item-1

Plaster (to wall, floor, ceiling etc.) with sand and cement mortar including rounding off or chamfering corners as directed and raking out joints including throating, nosing and drip course, scaffolding/staging where necessary (Ground floor).[Excluding cost of chipping over concrete surface] (i) With 1:4 cement mortar(c) 10 mm thick plaster ground floor

ceiling	1 X	5.00 x	6.00	=	30.00	m ²
beam	2 X	5.00 x	0.35	=	3.50	m ²
				Qty. =	33.500	m ²

@ Rs. 127.00 / m² = Rs. 4,255.00

(b) 20 mm thick plaster ground floor

(i) With 1:6 cement mortar Inside

	2 x	5.00 x	3.20	=	32.00	m ²
	2 x	6.00 x	3.20	=	38.40	m ²
Deduction & Door	1 x	0.90 x	1.00 x	2.10 =	-1.89	m ²
				Qty. =	68.51	m ²

@ Rs. 163.00 / m² = Rs. 11,167.00

(e) 15 mm thick plaster ground floor outside

(i) With 1:6 cement mortar

	2 x	5.50 x	3.30	=	36.30	m ²
	2 x	6.50 x	3.30	=	42.90	m ²
PARAPET	2 x	5.50 x	0.30	=	3.30	m ²
PARAPET	2 x	6.50 x	0.30	=	3.90	m ²
PARAPET	2 x	5.00 x	0.45	=	4.50	m ²
PARAPET	2 x	6.00 x	0.45	=	5.40	m ²
				Qty. =	96.30	m ²

@ Rs. 142.00 / m² = Rs. 13,675.00

7 P-192/item-15

Neat cement punning about 1.5mm thick in wall,dado,window sill,floor etc. NOTE:Cement 0.152 cu.m per100 sq.m.

dado	2 x	5.00 x	0.30	=	3.00	m ²
dado	2 x	6.00 x	0.30	=	3.60	m ²
				Qty. =	6.60	m ²

@ Rs. 34.00 / m² = Rs. 224.00

8 P-192/item-1

Labour for Chipping of concrete surface before taking up Plastering work.

Qty same as of 10 mm thick (1:4) plastering area

	33.500	=	33.50
		Qty. =	33.50 m ²

@ Rs. 21.00 / m² = Rs. 704.00

(P-40)

9 P-104/item-13 a ii

(a) M.S. or W.I. Ornamental grill of approved design joints continuously welded with M.S. W.I. Flats and bars of windows, railing etc. fitted and fixed with necessary screws and lugs in ground floor. (ii) Grill weighing above 16 Kg./sq.mtr and above

window	3	x	1.20	x	1.35	=	4.86	m ²	
door	1	x	0.90	x	2.10	=	1.89	m ²	
							6.75	m ²	
	6.75	@	18.00	kg		=	121.50	Kg	
							Qty. =	1.22	qnt

@ Rs. 9696.00 / m² Rmtl = = Rs. 11,781.00

10 P-105/item-15

Supplying 1.5mm thick M.S. sheet fitted and fixed on one or both faces of M.S./ W.I. gate etc. with point welding at not more than 150mm apart complete in all respect as per design including cost of all labour and materials.

front door	1	x	0.90	x	2.10	=	1.89	m ²	
							Qty. =	1.89	m ²

@ Rs. 1304.00 / sqm = = Rs. 2,465.00

11 P-196/item-10

Acrylic Distemper to interior wall, ceiling with a coat of solvent based interior grade acrylic primer (as per manufacturer's specification) including cleaning and smoothing of surface. Two Coats

ceiling	1		1	X	5.00	x	6.00	=	30.00	m ²
beam	1		2	X	5.00	x	0.35	=	3.50	m ²
	2	x	5.00	x	3.20	x		=	32.00	m ²
	2	x	6.00	x	3.20	x		=	38.40	m ²
Deduction & Door	1	x	0.90	x	1.00	x	2.10	=	-1.89	m ²
							Qty. =	102.01	m ²	

@ Rs. 70.00 / m² = = Rs. 7,141.00

12 P-196/item-8

Applying Exterior grade Acrylic primer of approved quality and brand on plastered or concrete surface old or new surface to receive decorative textured (matt finish) or smooth finish acrylic exterior emulsion paint including scraping and preparing the surface throughly, complete as per manufacturer's specification and as per direction of the EIC.

In Ground Floor: One Coat

outside side plaster area in sl.-6 marked G							=	96.30	m ²
							Qty. =	96.30	m ²

@ Rs. 3140.00 / %m² = = Rs. 3,024.00

13 P-197/item-17 a

Protective and Decorative Acrylic exterior emulsion paint of approved quality, as per manufacturer's specification and as per direction of EIC to be applied over acrylic primer as required. The rate includes cost of material, labour, scaffolding and all incidental charges but excluding the cost of primer.

In Ground floor (Two Coat) a) Normal Acrylic Emulsion So

96.30							=	96.30	m ²
							Qty. =	96.30	m ²

@ Rs. 67.00 / m² = = Rs. 6,452.00

14 P-200/item-1

(b) Priming one coat on steel or other metal surface with synthetic oil bound primer of approved quality including smoothing surfaces by sand papering etc.

area same as grill area sl-16

								=	6.75	m ²
front door	2.2	x	0.90	x	2.10		=	4.16	m ²	
							Qty. =	10.91	m ²	

@ Rs. 29.00 / m² = = Rs. 316.00

(P-41)

54

15 P-200/item-2

A) Painting with best quality synthetic enamel paint of approved make and brand including smoothening surface by sand papering etc. including using of approved putty etc. on the surface, if necessary : (a) On timber or plastered surface :
 b) On steel or other metal surface : With super gloss (hi-gloss) -(iv) Two coats (with any shade except white)
 area same as grill area sl-21

	@	Rs.	79.00	/	m ²	=	Qty.	=	10.91	m ²	=	Rs.	
			81.00	/	m ²	=			10.91	m ²	=		

(862.00)
~~884.00~~

16 P-212/item-21

Supplying, fitting & fixing UPVC pipes A- Type and fittings conforming to IS:13592-1992 with all necessary clamps nails, including making holes in walls, floor etc. cutting trenches in any soil through masonry concrete structures etc if necessary and mending good damages including joining with jointing materials (Spun Yarn, Valamoid/Bitumen/M-Seal etc)

(H) UPVC
 (11) 110 mm.

			3	x	3.90	x	1.00	=	11.70	m			
	@	Rs.	251.00	/	m	=	Qty.	=	11.70	m	=	Rs.	2,937.00

B) UPVC Fittings:c) Bend 87.5 degree

									3	no		
									3	no		

d) Shoe

	@	Rs.	160.00	/	m	=					=	Rs.	480.00
--	---	-----	--------	---	---	---	--	--	--	--	---	-----	--------

	@	Rs.	111.00	/	m	=	Qty.	=	3	no	=	Rs.	333.00
--	---	-----	--------	---	---	---	------	---	---	----	---	-----	--------

17 P-48/item-6

Artificial stone in floor, dado, staircase etc with cement concrete (1:2:4) with stone chips, laid in panels as directed with topping made with ordinary or white cement (as necessary) and marble dust in proportion (1:2 including smooth finishing and rounding off corners including raking out joints or roughening of concrete surface and applicatio of cement slurry before flooring works using cement @ 1.75 kg/sq.m all complete including all materials and labour In ground floor. 3 mm. thick topping (High polishing grinding on this item is not permitted with ordinary cement). Using grey cement (ii) 25 mm. thick room

			1	x	5.00	x	6.00	=	30.00	m ²			
	@	Rs.	262.00	/	m ²	=			30.00	m ²	=	Rs.	7,860.00

18 P-245/item-15

Supplying, fitting & fixing of 2-Track / 3-Track Aluminium sliding Window of all Aluminium sections viz. window frame (top, bottom & side frame), shutter (top, bottom, side & interlock member) made of aluminium alloy extrusions conforming to IS 733-1983 & IS 1285-1975, anodised conforming to IS 1868-1983, fitted with all other accessories viz. PVC roller, EPDM gasket, maruti lock, screws etc. including labour charges for fitting & fixing of aluminium 2-track/3-track sliding window with fixing of glass (excluding cost of glass) all complete as per architectural drawings and direction of Engineer-in-charge. 10-12 Micron thickness Anodizing film

Window			3	X	1	x	1.200	x	1.35	=	4.8600	m ²
		@					5.50	kg/m ²		=	26.7300	kg
	@	Rs.	448.00	/	kg/m ²					=	Rs.	11,975.00

(P-42)

19 P-249/item-24

Supplying bubble free float glass of approved make and brand conforming to IS: 2835-1987 (A) clear toughened glass conforming to IS : 2553-1992 (part - ii)
6mm thick coloured / tinted / smoke glass.

Window	3 X	1 x	1.200	x	1.35	=	4.8600	m ²	
@	Rs.	957.00	/	m ²	=				Rs. 4,651.00 ✓
									TOTAL (A) 317996.75 302919.00
									Add 12% GST on "A", (B)= 39158.03 36350.00
									Cost of civil work excluding cess (C), SUM OF "A+B"= 356144.33 339269.00
									Add 1% cess on (C), D= 3561.44 3393.00
									Cost of civil work including cess (E), SUM OF "C+D"= 359705.77 342662.00
									Add 3% contingency on (C)= 10683.07 40178.00
									GRAND TOTAL= 362840.00 (370388.77) ✓

M. Malika
25.09.18

Junior Engineer, Sec-III PWD,
Jangipur Sub-Division

S. S. S.
25/09/18

Assistant Engineer PWD
Jangipur Sub-Division

S. S. S.
25/09/18

Executive Engineer
Berhampore Division No.1, PWD

(P-43)

H. H.
19/12/2018

Block Medical Officer of Health
Anupnagar B. P. H. C.
Dhulian, Murshidabad

S. S. S.
19/12/18
Chief Medical Officer of Health
Murshidabad

(SL NO-22)

Electrical Estimate :- Rs. 4,71,42,979/-

Estimate No- 101/MsdEd of 2018-19

Name Of Work:- Proposed construction of G+3 Storied Mother and Child Hub (Foundation to be taken G+5) at the premises of Anupnagar BPHC, Samsanganj Block, Murshidabad during the year 2018-19. Electrical Work.

Ref:- Memo no- CM/Msd/Dev- 4902, Dated:- Berhampore, the 4th, June'2018 and Order by Programme Officer, NHM/NRHM-342/2016/5184/2815(1), dt. 29.05.2018

Report:- This estimate has been framed to meetup the probable expenditure for aforesaid work. Estimate is prepared as per architectural drawing received from PWD civil wings and in accordance with the discussion with the Authority of Family welfare and Health Department. The total Electrical load is likely to be 500 KVA therefore 1000 KVA Sub-Station (2X500KVA) is considered with anticipating the future provision of load as per guide line of higher authority. Estimate is prepared considering the cost of E.I work, Air-Conditioning system, Lift, Sub-Station including UPS and CCTV etc.

PLINTH AREA RATE & FORMAT FOR PREPARATION OF PRELIMINARY/ROUGH COST ESTIMATE (ELECTRICAL WORKS)

SL No	DESCRIPTION OF WORKS	RATE	UNIT	QTY	AMOUNT
A. SERVICE CONNECTION CHARGES					
1	Cost of Service Connection Charges payable to CESC / WBSEDCL authority. [The actual amount will be as per quotation to be submitted by the CESC / WBSEDCL authority]	3600000	LS	1	₹ 36,00,000.00
B. INTERNAL ELECTRICAL INSTALLATION					
2	Internal Electrical Installation work [N.B. It Includes all electrical installation, like SITC of Building panel, Rising Main, Cable from panel / Rising Main to VTPNDB / TPNDB, Distribution wiring to all the electrical utilities including TPNDB/ SPNDB, Electrical fittings, Fans and other accessories etc excluding the following]. (Total structural cost is 62729745.00) 63969945.00	12793989.00 12545949 11230000 12545949	LS	1	12793989.00 12545949.00 ₹ 1,12,30,000.00
C. LIGHTNING PROTECTION SYSTEM					
3	Supply and fixing of lightning protective system conforming to IS : 2309 with all standard accessories such as metal Air finials on the top of the building, complete with down conductors and earthing as per specification of works.		0.505 % of structural cost.		
3.1	Upto 4 Storyed Building	316785	LS	1	₹ 3,16,785.00
D. COMPOUND LIGHTING SYSTEM					
4	SITC of Compound lighting System with HPSV /LED Fittings including feeder pillar box, pole, fittings with lamp & cable etc including all accessories.				
4.1	Upto 7 Mtr Pole Height from GL (Road Area 1322 Sq.mtr)	250.00	Per Sq-mtr (Road Area)	1322	₹ 3,30,500.00
E. INTELLIGENT FIRE ALARM SYSTEM					
5	SITC of Intelligent addressable fire alarm system with FACF , detectors, MCP, sounders with all accessories & wires including testing and getting statutory approvals. (Carpet Area 3821 Sqmtr). Total Area (4776) x 0.8 = 3821 Sq.Mtr.	505.00	Per Sq-mtr (Carpet Area)	3821	₹ 19,29,605.00
F. SUBSTATION EQUIPMENTS					
6	SITC of Sub-Station Equipments (11 / 6 KV) comprising of HT Panel, Transformer (Cast Resin Dry Type / Oil), Substation LT Panels, APFC Panel, HT cable, LT Cable / Bus Trunking within substation including substation building wiring, Earthing and safety equipments for the following Capacity.				

6.1	2 X (400 to 500) KVA	7500.00	Per KVA	1000	₹ 75,00,000.00
G. CABLES FROM SUBSTATION TO BUILDINGS					
7	Supplying of one number 1.1 KV Grade XLPE insulated and PVC sheathed aluminium conductor cable (Armoured) conforming to IS: 7098 / 1988 with its latest amendment and laying those in underground trenches incld. Socketing and finishing the ends of the socket of following size				
7.1	3.5 Core 400 Sq. mm	1800.00	Per metre	200	₹ 3,60,000.00
H. BUS-DUCTING FROM SUBSTATION TO BUILDING					
8	SITC of compact air insulated Bus Ducting (For Horizontal Run outside the Sub-station) separators, flexible joints, bends, elbows and earthing having 50KV breaking capacity and IP-54 protection				
With Copper bus bar					
8.1	1250A	46200.00	per mtr	50	₹ 23,10,000.00
I. DG SET / UPS					
9	SITC of silent Diesel Generator set, AMF Panel, Bus Trunking / Cables from AMF / DG Panel to Essential Pannel, Control cable, DG Set Exhaust piping as per CPCB Norms, Fuel/ Lubricating Oil, Earthing of DG Set & AMF Panel including Construction of DG Foundation and allied works.				
9.1	Above 100 KVA	10000.00	Per KVA	320	₹ 32,00,000.00
9.2	SITC of online UPS system with 30 minutes backup including batteries.	20000.00	do	95	₹ 19,00,000.00
9.3	Add for every additional 30 minutes backup	8000.00	do	95	₹ 7,60,000.00
J. AIR-CONDITIONING SYSTEM					
10	SITC of energy efficient Precision <i>VRF/Ductless Split</i> Air-conditioning system i.e. indoor unit, outdoor unit, piping, cabling, electrical panel <i>with treated fresh air system</i>	100000.00 55000	Per Ton-HP	90 75	₹ 90,00,000.00 4125000.00
11	SITC of Room Air-conditioning system (Split type) i.e. indoor unit, outdoor unit, piping, cabling, electrical panel (5 Star)	34000.00	do	38.5	₹ 13,09,000.00
K. LIFT					
12	SITC of gearless Automatic Lift with ACVVVF drive (as per manufacturer design & conforming to IS) and putting into operation after final testing in the existing lift shaft complete with all accessories and repairing the damage wall / floor if any etc complete as reqd including necessary civil works having following capacity and speed. [Make : Category I]				
12.1	20 passenger (G+4), speed 0.75m/s [Bed Lift]	2424000.00	Per Set	3	₹ 72,72,000.00
L. CCTV					
13	SITC of IP based CCTV system for building security comprising of PTZ, fixed camera, cabling, recording, display system and Hardware & Software support.	300.00	Per Sq-mt (Carpet Area)	1187	₹ 3,56,100.00
M. Miscellaneous					
14	SITC of LED sign board	320000.00	set	2	₹ 6,40,000.00
15	SITC of LAN	750000.00	LS	1	₹ 7,50,000.00
Total					₹ 5,27,63,990.00
Add : Labour Welfare Cess @1% on Estimated Amount					₹ 5,27,640.00

P-2/3

58

46894939.00
43142979.00
P-20.

	Add : GST @12% on Estimated Amount	₹ 63,31,679.00
		₹ 5,96,23,309.00
	Add : Contingency @3%	₹ 17,88,699.00
		₹ 6,14,12,008.00
(Rupees Six crore fourteen lakh twelve thousand eight only)		

R. 4,71,42,979.00

[Signature]
14/6/18

Assistan Engineer, PWD
Murshidabad Electrical Sub-Division

[Signature]
19/6/18

Executive Engineer, PWD
Murshidabad Electrical Division

[Signature]
28/02/18

Junior Engineer Electrical
Head Quarter & Planning
P.W.D.

[Signature]
Superintending Engineer, P.W.D.
Central Electrical Circle

[Signature]
28/06/18
Executive Engineer (Electrical)
H.Q. & Planning, P.W.D.
Govt. of West Bengal

[Signature]
Assistant Chief Engineer (EL)
H.Q. & Planning, P.W.D.
Govt. of West Bengal

[Signature]
28-6-18
Chief Engineer Electrical
Public Works Directorate
Govt. of West Bengal
4,71,42,979.00
~~1,68,94,939/-~~

Estimate Vetted
Vetted Amount Stand for Rs. ~~1,68,94,939/-~~

[Signature]
02.07.18
Superintending Engineer, P.W.D.
Electrical Planning & Monitoring Circle

[Signature]
2-7-18
Chief Engineer Electrical Planning
Public Work Department
HQ & Planning
Govt. of West Bengal

[Signature]
19/12/18
Block Medical Officer of Health
Anupnagar B. P. H. C.
Dhulyan, Murshidabad

[Signature]
19/12/18
Chief Medical Officer of Health
Murshidabad

a.	G+3	20 passenger	0.75 m/s	3							22
8 LIGHTNING PROTECTION SYSTEM (AS PER IS : 2309)											
	Name of the Building	Whether Protection Is Necessary	Height Of the Building	Roof Area							
a.		Yes	13.2 mtr	960 Sq.mtr							
11 CCTV SYSTEM											
	Name of the Building	Whether Necessary	Carpet Area To be Covered (Sq.Mtr)						Total Connected Load(KW)	Max Demand (KW)	
		Yes	1187						2	2	
12 FIRE DETECTION SYSTEM											
	Name of the Building		Total Carpet Area to Be covered								Max Demand(KW)
a.			3821								0.5
13 SUBSTATION											
	Name of the Building	MAXIMUM DEMAND (KW)									
		LIGHT/FAN/PLUGS	AC	Lift	PA	Stage	CCTV	Fire Detection	IT INFRA	SUM OF MD(KW)	Emergency Load (KW)
a.		252 KW	102 KW	22 KW			2 KW	0.5 KW		378.5	-87
1	Compound Lighting									3.4	3.4
2	No of Pumps with Capacity in KW (Water Supply) (2x7.5 HP)									11	5.5
3	No of Pumps with Capacity in KW (Fire Fighting) (75 HP)									56	-56
	Sum of the Individual Maximum Demand (IN KW)									448.9	151.9
	Sum of the Individual Maximum Demand (IN KVA)									561.125	189.875
	Simultaneous Maximum Demand (Using Diversity Factor -1.42)									395.16	
	Add Loading Factor (80 % For Oil / 90 % For Dry Type)									439.06	
	Add Future Provision 25 % [100 % For Hospital]									439.06	
	Proposed Number & Capacity of The Transformer									2 x 500 KVA	
	Proposed Number & Capacity of the DG Set									1 x 320 KVA	

200.5
215.4
200.25
336.25

20/11/18
Junior Engineer Electrical
Head Quarter & Planning
P.W.D.

14/11/18
Assistant Engineer PWD
MURSHIDABAD ELECT. SUB-DIVN.

14/11/18
Executive Engineer, PWD
Murshidabad Electrical Division

20/11/18
Executive Engineer (Electrical)
H.Q. & Planning, P.W.D.
Govt. of West Bengal

Chief Engineer Electrical
Public Works Directorate
Govt. of West Bengal

For
Superintending Engineer, P.W.D.
Central Electrical Circle

20/11/18
Chief Medical Officer Health
Murshidabad
Assistant Chief Engineer (EL)
H.Q. & Planning, P.W.D.
Govt. of West Bengal

19/12/2018
Block Medical Officer of Health
Anupnagar B. P. Chaudhary
Dhulyan, Murshidabad
Chief Engineer Electrical
Public Works Directorate
Govt. of West Bengal

60